

MULTIFLEX

MORSE e CUBI-MORSA - VISES and VISE-TOWERS

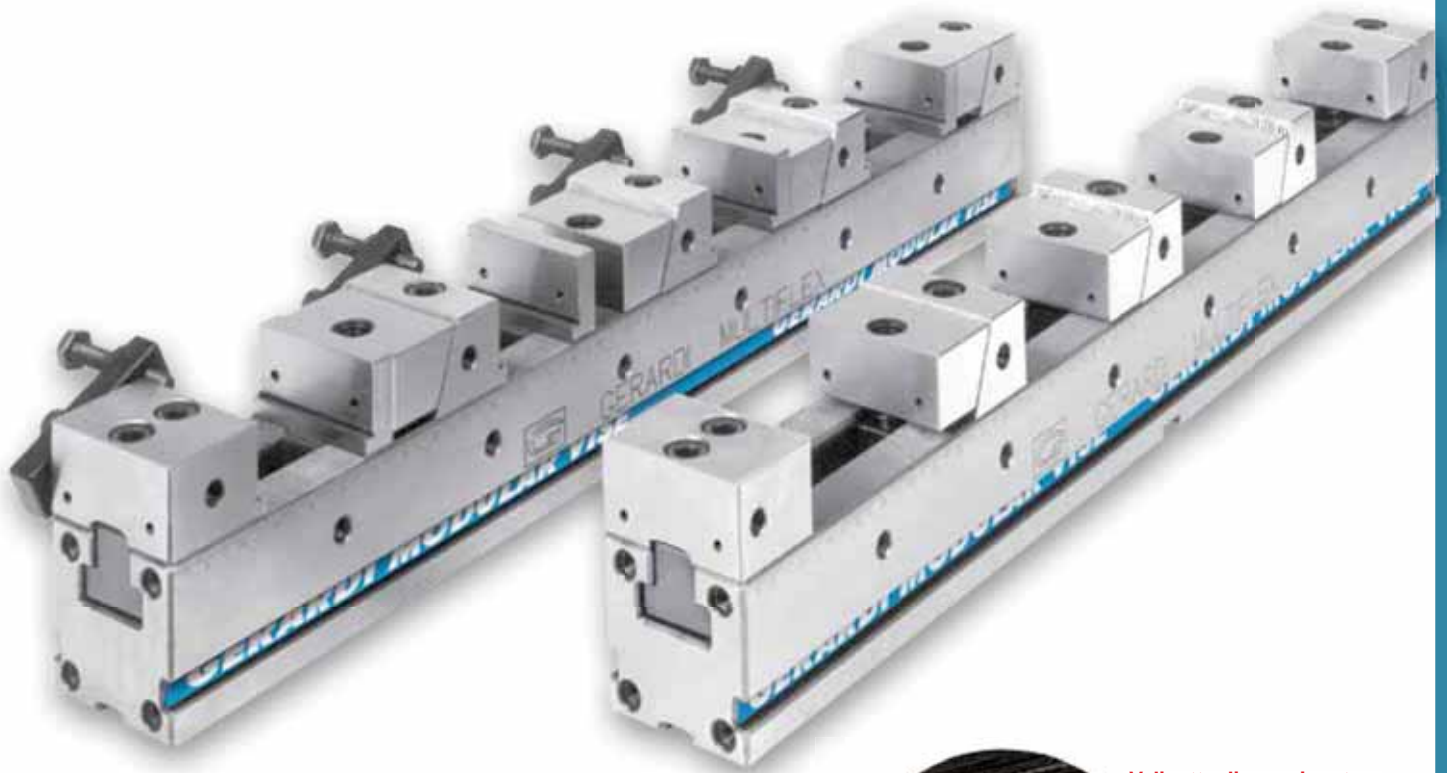

Valigetta di campionatura
Sample Kit case for Art.600

Art. 984

SISTEMA MODULARE MULTIPLO
MULTIPLE MODULAR SYSTEM

MORSE e CUBI-MORSA serie MULTIFLEX MULTIFLEX VISES and VISE-TOWERS series

Pagg. 6.2 - 6.40

Le morse della serie **MULTIFLEX** rappresentano un innovativo sistema modulare di serraggio in grado di sfruttare al massimo la capacità della tavola della macchina e di aumentarne, di conseguenza, la produttività.

The **MULTIFLEX** series vises are a total new concept of modular clamping system able to maximize the machine table capacity and thus to increase its productivity.

Il sistema è stato ideato per poter serrare contemporaneamente un notevole numero di pezzi sulla tavola della macchina utensile, riducendo così notevolmente i tempi morti.

This system is designed for clamping several workpieces at the same time on the machine tool table, thus reducing tool changeover times.

USURA INESISTENTE costruzione in acciaio temprato durezza 60±2 HRC

NO WEAR made of high alloyed quality steel, hardness 60±2 HRC.

GARANZIA DI MASSIMA PRECISIONE di posizionamento ed allineamento della ganasce grazie alla rettificazione dal pieno della dentatura di ancoraggio della base

HIGHEST ACCURACY in positioning and alignment ($\pm 0,02$ mm) thanks to the ground rack teeth on both the base and the fixed jaws

TEMPI MINIMI DI SET UP E DI SERRAGGIO PEZZO posizionamenti ed ancoraggi delle ganasce sul corpo base di rapida esecuzione ed in prossimità del particolare da lavorare

MINIMUM OF SET UP AND CLAMPING TIMES quick and versatile jaws positioning very close to the workpiece

VERSATILITÀ possibilità di allineamento ed accoppiamento di ganasce e più morse su qualsiasi posizione della dentatura della base.

VERSATILITY possibility of vises matching and jaws alignment on whatever position on the vise base.

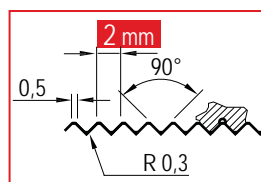

2 mm = Passo delle righe
Rows pitch

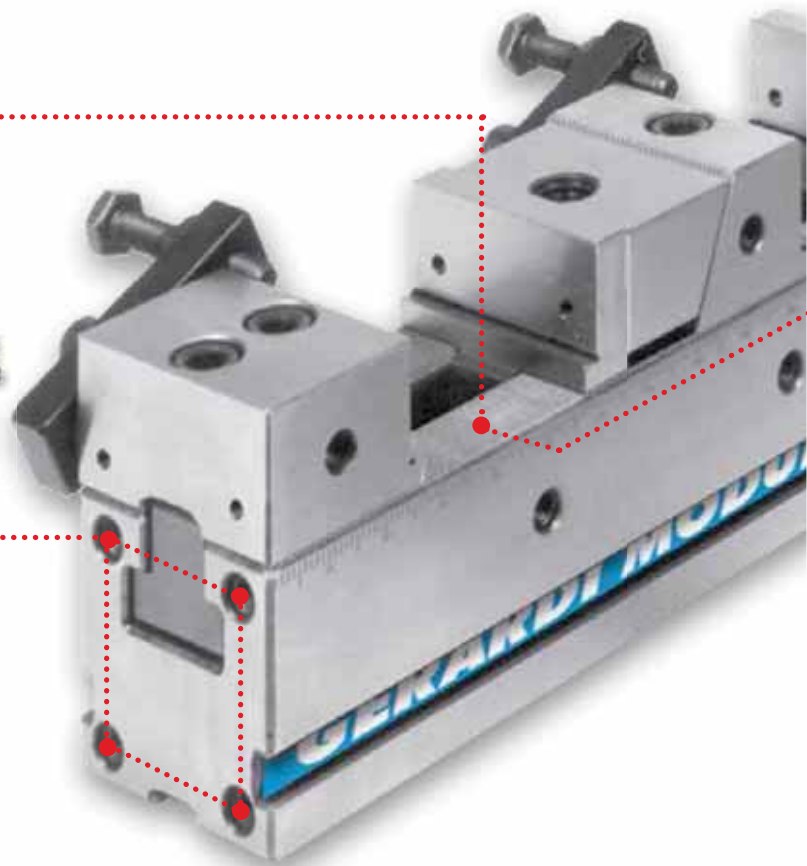
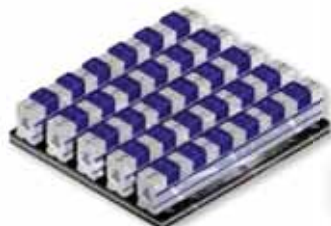
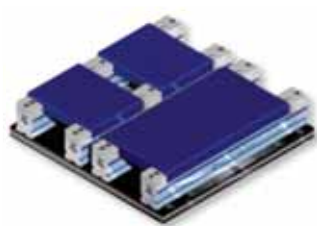

PREDISPOSIZIONE VERTICALE

tramite distanziali, strutture portapezzi o cubi-morsa verticali.
Le morse modulari **MULTIFLEX** possono essere assemblate verticalmente, legate fra loro o montate su specifiche strutture portapezzi

VERTICAL SET UP through spacers, tombstones or vise-towers.

MULTIFLEX vises can be vertically assembled linked each other or clamped to specific workholding structures.

MULTIFLEX: le più versatili ! Per serraggi multipli fino a 12 pezzi anche di dimensioni differenti

Series MULTIFLEX: the most versatile vise ! For flexible clamping of multiple workpieces of various sizes



GAMMA ILLIMITATA DI SERRAGGI (ganasce a gradino, zigrinate, lisce, per tondi, dolci, doppie, ecc.)

La posizione, il numero il numero o tipo di ganasce può variare a seconda delle necessità di serraggio (possibilità di bloccare da 1 a 12 pezzi sulla stessa morsa)

UNLIMITED CLAMPING RANGE (step jaws, serrated, flat, prismatic, soft, double, etc.)

The jaws positioning, number or type could vary according to the workholding needs (from 1 to 12 pcs. clamping possibility on the same vise base)

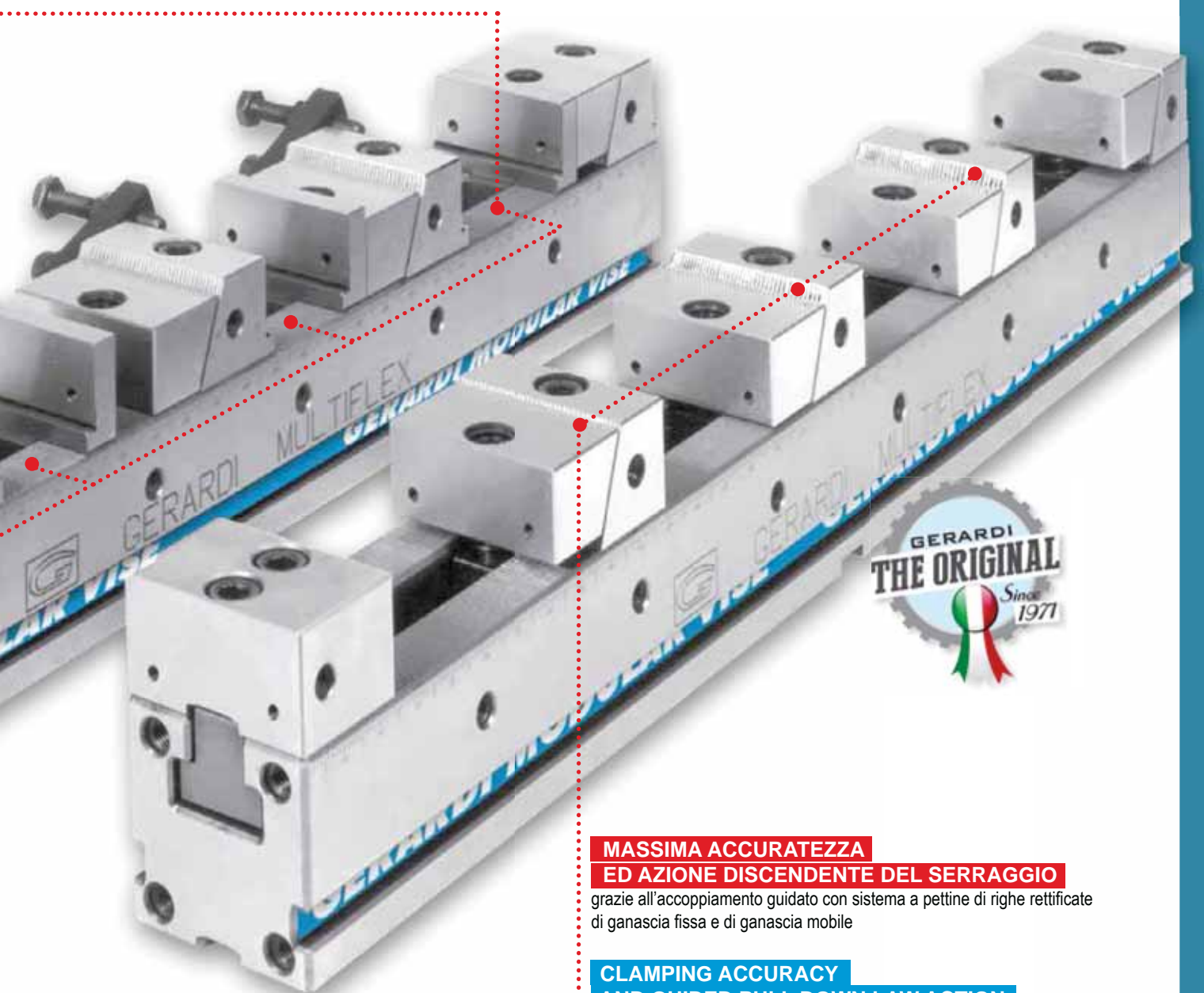

MASSIMA ACCURATEZZA

ED AZIONE DISCENDENTE DEL SERRAGGIO

grazie all'accoppiamento guidato con sistema a pettine di righe rettificate di ganasce fissa e di ganasce mobile

CLAMPING ACCURACY

AND GUIDED PULL DOWN LAW ACTION

thanks to the ground comb-teeth even between the fixed and movable jaws



Guida rapida per la scelta della morsa MULTIFLEX più adatta alle vostre esigenze

Tipo (grandezza) morsa / Vise type (size)

Art. 600

Art. 600S

Ogni morsa è completa di
1 ganaschia fissa, 4 ganasce fisse-mobili
1 chiave a T, 2 tasselli di posizionamento
e 4 arresti laterali

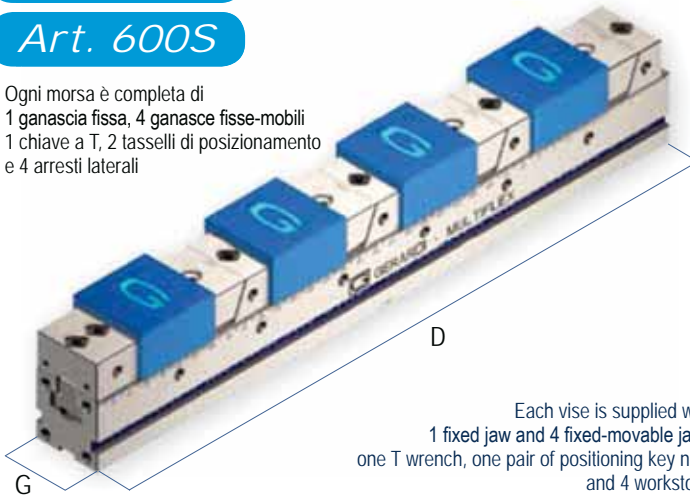

Each vise is supplied with
1 fixed jaw and 4 fixed-movable jaws
one T wrench, one pair of positioning key nuts
and 4 workstops

Apertura max in relazione al numero dei pezzi

Max opening according to pieces to be clamped

kN	1 20 kN		
	300	400	500
D	300	400	500
$G_{-0,02}^0$	50	50	50
1 pezzo / piece	205	305	408
2 pezzi / pieces	75	125	175
3 pezzi / pieces	30	64	96
4 pezzi / pieces	8	33	58
5 pezzi / pieces	-	15	35
6 pezzi / pieces	-	3	19
7 pezzi / pieces	-	-	8
8 pezzi / pieces	-	-	-
9 pezzi / pieces	-	-	-
10 pezzi / pieces	-	-	-
11 pezzi / pieces	-	-	-
12 pezzi / pieces	-	-	-
Cod. Art. 600	6.60.01300	6.60.01400	6.60.01500
Cod. Art. 600S	6.60.0S130	6.60.0S140	6.60.0S150

Art. 606

Ogni morsa è completa di
1 ganaschia fissa, 4 ganasce fisse-mobili
1 chiave a T, 2 tasselli di posizionamento
e 4 arresti laterali

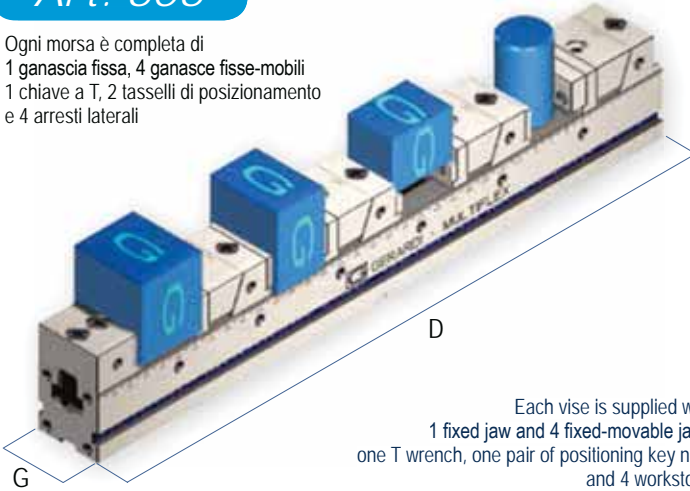

Each vise is supplied with
1 fixed jaw and 4 fixed-movable jaws
one T wrench, one pair of positioning key nuts
and 4 workstops

Apertura max in relazione al numero dei pezzi

Max opening according to pieces to be clamped

D	300 *	400	500
	$G_{-0,02}^0$	50	50
1 pezzo / piece	193	293	393
2 pezzi / pieces	63	113	163
3 pezzi / pieces	19	53	86
4 pezzi / pieces	-	23	48
5 pezzi / pieces	-	-	25
6 pezzi / pieces	-	-	-
7 pezzi / pieces	-	-	-
8 pezzi / pieces	-	-	-
9 pezzi / pieces	-	-	-
10 pezzi / pieces	-	-	-
11 pezzi / pieces	-	-	-
12 pezzi / pieces	-	-	-
Cod.	6.60.61300	6.60.61400	6.60.61500

* Solo tipo 1 x 300 e 2 x 400 n. 3 ganasce fisse-mobili in dotazione
Only type 1 x 300 and 2 x 400 n. 3 fixed-movable jaws included

Art. 611

Ogni morsa è completa di
3 ganasce fisse, 2 ganasce mobili di spinta
1 chiave a T, 2 tasselli di posizionamento
e 4 arresti laterali

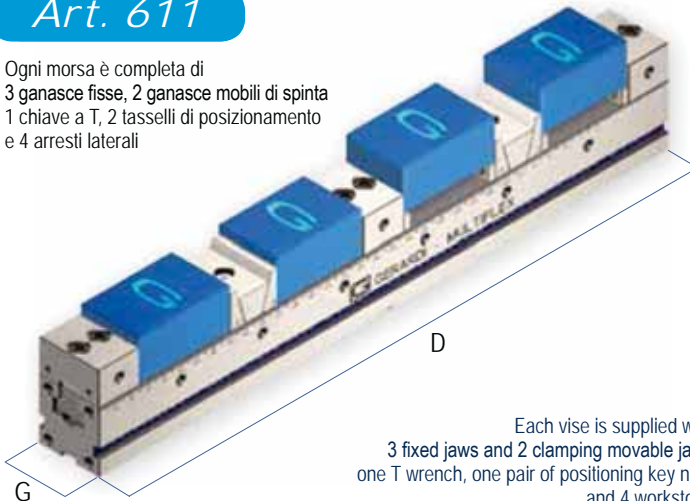

Each vise is supplied with
3 fixed jaws and 2 clamping movable jaws
one T wrench, one pair of positioning key nuts
and 4 workstops

Apertura max in relazione al numero dei pezzi

Max opening according to pieces to be clamped

D	300	400	500
	$G_{-0,02}^0$	50	50
1 pezzo / piece	174	274	374
2 pezzi / pieces	87	137	185
3 pezzi / pieces	28	62	95
4 pezzi / pieces	21	46	71
5 pezzi / pieces	-	19	39
6 pezzi / pieces	-	16	33
7 pezzi / pieces	-	-	15
8 pezzi / pieces	-	-	13
9 pezzi / pieces	-	-	2
10 pezzi / pieces	-	-	-
11 pezzi / pieces	-	-	-
12 pezzi / pieces	-	-	-
Cod.	6.61.11300	6.61.11400	6.61.11500

Quick guide for the proper MULTIFLEX vise choice according to your specific application

1 20 kN		2 30 kN						3 40kN			
600	700	400	500	600	700	800	900	700	800	900	1000
50	50	75	75	75	75	75	75	100	100	100	100
508	608	275	375	475	575	675	755	532	632	732	832
225	275	100	150	200	250	300	350	217	267	317	367
129	161	41	75	108	141	175	280	112	145	178	211
83	108	12	37	62	87	112	137,5	59	84	109	134
55	75	-	15	35	55	75	95	28	48	68	88
36	52	-	-	16	33	50	66,5	7	23	39	55
22	36	-	-	3	17	32	46	-	6	2	34
12	24	-	-	-	6	18	31	-	-	5	18
5	16	-	-	-	-	8	19	-	-	-	5
-	8	-	-	-	-	-	10	-	-	-	-
-	2	-	-	-	-	-	2	-	-	-	-
-	-	-	-	-	-	-	-	-	-	-	-
6.60.01600	6.60.01700	6.60.02400	6.60.02500	6.60.02600	6.60.02700	6.60.02800	6.60.02900	6.60.03700	6.60.03800	6.60.03900	6.60.03100
6.60.0S160	6.60.0S170	6.60.0S240	6.60.0S250	6.60.0S260	6.60.0S270	6.60.0S280	6.60.0S290	6.60.0S370	6.60.0S380	6.60.0S390	6.60.0S310

600	700	400 *	500	600	700	800	900	700	800	900	1000
50	50	75	75	75	75	75	75	100	100	100	100
493	593	262	362	462	562	662	762	512	612	712	812
213	263	87	137	187	237	287	337	197	247	294	347
119	152	28	62	95	128	162	195	92	125	158	191
73	97	-	24	49	74	99	124,5	39	64	89	114
45	64	-	2	22	42	62	82	8	28	48	68
26	42	-	-	3	20	37	53,5	-	3	20	37
13	26	-	-	-	4	19	33	-	-	-	14
-	14	-	-	-	-	5	18	-	-	-	-
-	5	-	-	-	-	-	6	-	-	-	-
-	-	-	-	-	-	-	-	-	-	-	-
-	-	-	-	-	-	-	-	-	-	-	-
-	-	-	-	-	-	-	-	-	-	-	-
6.60.61600	6.60.61700	6.60.62400	6.60.62500	6.60.62600	6.60.62700	6.60.62800	6.60.62900	6.60.63700	6.60.63800	6.60.63900	6.60.63100

600	700	400	500	600	700	800	900	700	800	900	1000
50	50	75	75	75	75	75	75	100	100	100	100
474	574	242	342	442	542	642	792	470	570	670	770
237	287	121	171	221	271	321	371	235	285	335	285
128	162	45	78	112	145	178	228	103	136	169	202
96	121	34	59	84	109	134	158,5	77	102	127	152
59	79	5	25	45	65	85	115	30	50	70	90
49	66	-	21	38	54	71	87,5	25	41	57	73
30	44	-	3	17	31	46	66,5	-	12	26	40
26	38	-	-	15	27	40	52	-	11	23	35
13	24	-	-	1	12	23	40	-	-	3	14
12	22	-	-	-	11	21	31	-	-	-	-
3	12	-	-	-	-	10	22,5	-	-	-	-
2	11	-	-	-	-	9	16,5	-	-	-	-
6.61.11600	6.61.11700	6.61.12400	6.61.12500	6.61.12600	6.61.12700	6.61.12800	6.61.12900	6.61.13700	6.61.13800	6.61.13900	6.61.13100

Guida rapida per la scelta della morsa MULTIFLEX più adatta alle vostre esigenze

GANASCIA Tipo 1 (49mm) su BASE Tipo 2 / JAW Type 1 (49mm) on BASE Type 2

Art. 632

Art. 632S

Ogni morsa è completa di
 1 ganascia fissa, 4 ganasce fisse-mobili
 1 chiave a T, 2 tasselli di posizionamento
 e 4 arresti laterali

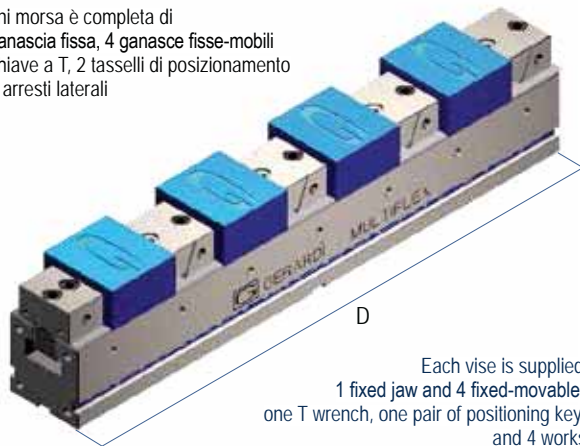

Each vise is supplied with
 1 fixed jaw and 4 fixed-movable jaws
 one T wrench, one pair of positioning key nuts
 and 4 workstops

Base Tipo 2 - Base Type 2

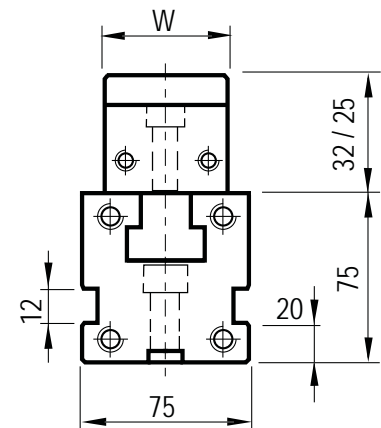

Art. 652

Ogni morsa è completa di
 1 ganascia fissa, 4 ganasce fisse-mobili
 1 chiave a T, 2 tasselli di posizionamento
 e 4 arresti laterali

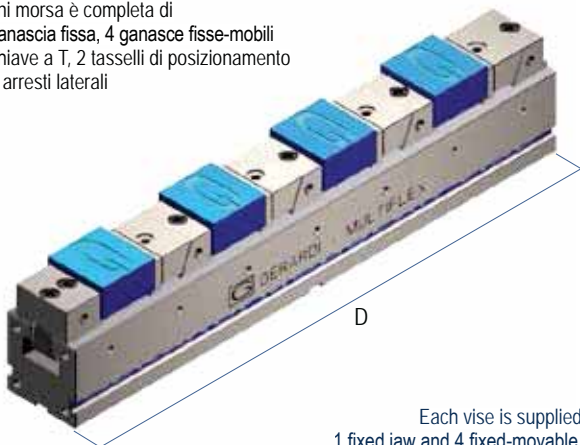

Each vise is supplied with
 1 fixed jaw and 4 fixed-movable jaws
 one T wrench, one pair of positioning key nuts
 and 4 workstops

Base Tipo 2 - Base Type 2

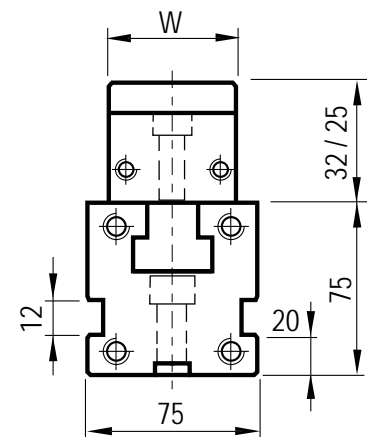

Art. 692

Ogni morsa è completa di
 3 ganasce fisse, 2 ganasce mobili di spinta
 1 chiave a T, 2 tasselli di posizionamento
 e 4 arresti laterali

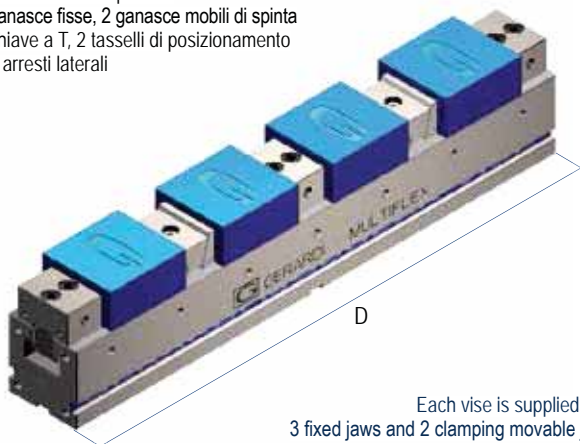

Each vise is supplied with
 3 fixed jaws and 2 clamping movable jaws
 one T wrench, one pair of positioning key nuts
 and 4 workstops

Base Tipo 2 - Base Type 2

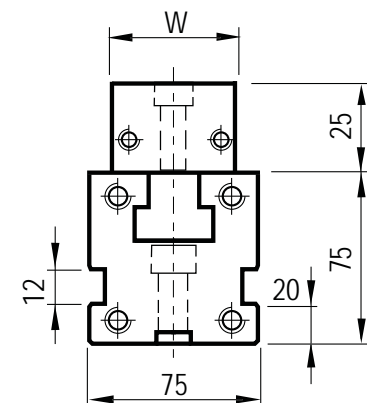

Quick guide for the proper MULTIFLEX vise choice according to your specific application

GANASCIA Tipo 1 - / JAW Type 1

kN

20 kN

D	400	500	600	700	800	900
W	49					
1 pezzo / piece	304	404	504	604	704	804
2 pezzi / pieces	123	173	223	273	323	373
3 pezzi / pieces	62,7	96	129,3	162,7	196	229,3
4 pezzi / pieces	32,5	57,5	82,5	107,5	132,5	157,5
5 pezzi / pieces	14,4	34,4	54,4	74,4	94,4	114,4
6 pezzi / pieces	2,3	19	35,7	52,3	69	85,7
7 pezzi / pieces	-	8	22,3	36,6	50,9	65,1
8 pezzi / pieces	-	-	12,3	24,8	37,3	49,8
9 pezzi / pieces	-	-	4,4	15,6	26,7	37,8
10 pezzi / pieces	-	-	-	8,2	18,2	28,2
11 pezzi / pieces	-	-	-	2,2	11,3	20,4
12 pezzi / pieces	-	-	-	-	5,5	13,8
13 pezzi / pieces	-	-	-	-	11,3	8,3
Cod. Art. 632	6.63.21400	6.63.21500	6.63.21600	6.63.21700	6.63.21800	6.63.21900
Cod. Art. 632S	6.63.2S140	6.63.2S150	6.63.2S160	6.63.2S170	6.63.2S180	6.63.2S190

Apertura max in relazione al numero dei pezzi
Max opening according to pieces to be clamped

D	400	500	600	700	800	900
W	49					
1 pezzo / piece	296	396	496	596	696	796
2 pezzi / pieces	115	165	215	265	315	365
3 pezzi / pieces	54,7	88	121,3	154,7	188	221,3
4 pezzi / pieces	24,5	49,5	74,5	99,5	124,5	149,5
5 pezzi / pieces	6,4	26,4	46,4	66,4	86,4	106,4
6 pezzi / pieces	-	11	27,7	44,3	61	77,7
7 pezzi / pieces	-	0	14,3	28,6	42,9	57,1
8 pezzi / pieces	-	-	4,3	16,8	29,3	41,8
9 pezzi / pieces	-	-	-	7,6	18,7	29,8
10 pezzi / pieces	-	-	-	0,2	10,2	20,2
11 pezzi / pieces	-	-	-	-	3,3	12,4
12 pezzi / pieces	-	-	-	-	-	5,8
Cod.	6.65.21400	6.65.21500	6.65.21600	6.65.21700	6.65.21800	6.65.21900

Apertura max in relazione al numero dei pezzi
Max opening according to pieces to be clamped

D	400	500	600	700	800	900
W	49					
1 pezzo / piece	277	377	477	577	677	777
2 pezzi / pieces	138,5	188,5	238,5	288,5	338,5	388,5
3 pezzi / pieces	64	97,3	130,7	164	197,3	230,7
4 pezzi / pieces	48	73	98	123	148	173
5 pezzi / pieces	21,4	41,4	61,4	81,4	101,4	121,4
6 pezzi / pieces	17,8	34,5	51,2	67,8	84,5	101,2
7 pezzi / pieces	3,1	17,4	31,7	46	60,3	74,6
8 pezzi / pieces	2,8	15,3	27,8	40,3	52,8	65,3
9 pezzi / pieces	-	4,1	15,2	26,3	37,4	48,6
10 pezzi / pieces	-	3,7	13,7	23,7	33,7	43,7
11 pezzi / pieces	-	-	4,7	13,8	22,9	32
12 pezzi / pieces	-	-	4,3	12,7	21	29,3
13 pezzi / pieces	-	-	-	5,2	12,8	20,5
14 pezzi / pieces	-	-	-	1,4	8,6	15,7
15 pezzi / pieces	-	-	-	-	5,5	12,1
16 pezzi / pieces	-	-	-	-	2,2	8,4
17 pezzi / pieces	-	-	-	-	-	5,7
Cod.	6.69.21400	6.69.21500	6.69.21600	6.69.21700	6.69.21800	6.69.21900

Apertura max in relazione al numero dei pezzi
Max opening according to pieces to be clamped

Guida rapida per la scelta della morsa MULTIFLEX più adatta alle vostre esigenze

GANASCIA Tipo 1 o Tipo 2 (49 o 74mm) su BASE Tipo 3 / JAW Type 1 or Type 2 (49 or 74mm) on BASE Type 3

Art. 633

Art. 633S

Ogni morsa è completa di
1 ganascia fissa, 4 ganasce fisse-mobili
1 chiave a T, 2 tasselli di posizionamento
e 4 arresti laterali

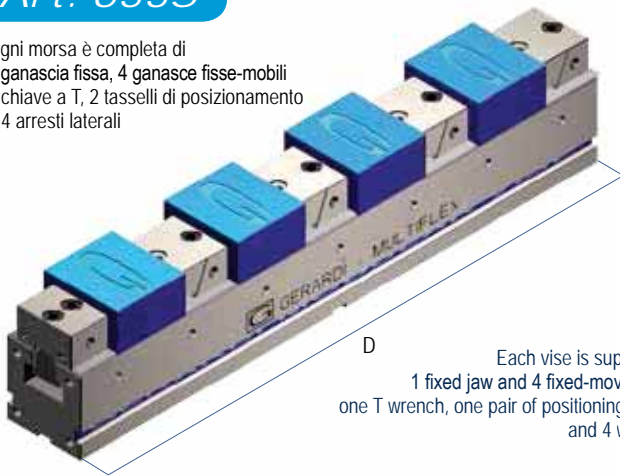

Each vise is supplied with
1 fixed jaw and 4 fixed-movable jaws
one T wrench, one pair of positioning key nuts
and 4 workstops

Base Tipo 3 - Base Type 3

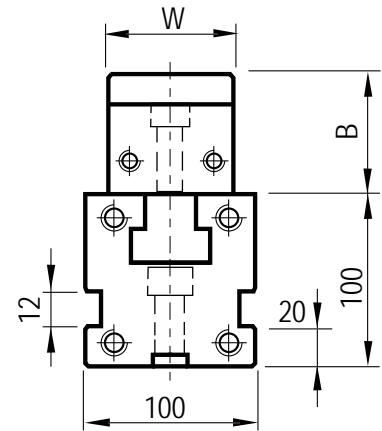

Vedi quota B pag. 6.17 - For dimension B see page 6.17

Art. 653

Ogni morsa è completa di
1 ganascia fissa, 4 ganasce fisse-mobili
1 chiave a T, 2 tasselli di posizionamento
e 4 arresti laterali

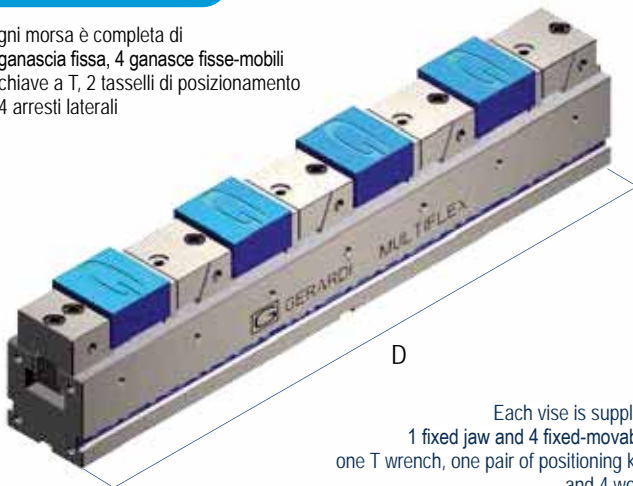

Each vise is supplied with
1 fixed jaw and 4 fixed-movable jaws
one T wrench, one pair of positioning key nuts
and 4 workstops

Base Tipo 3 - Base Type 3

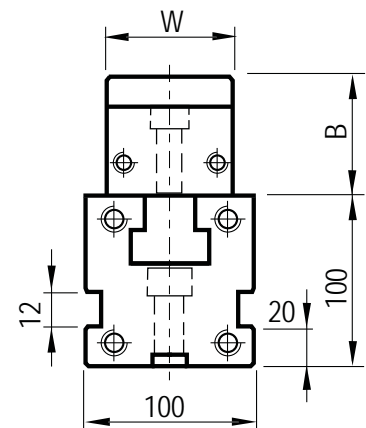

Vedi quota B pag. 6.17 - For dimension B see page 6.17

Art. 693

Ogni morsa è completa di
3 ganasce fisse, 2 ganasce mobili di spinta
1 chiave a T, 2 tasselli di posizionamento
e 4 arresti laterali

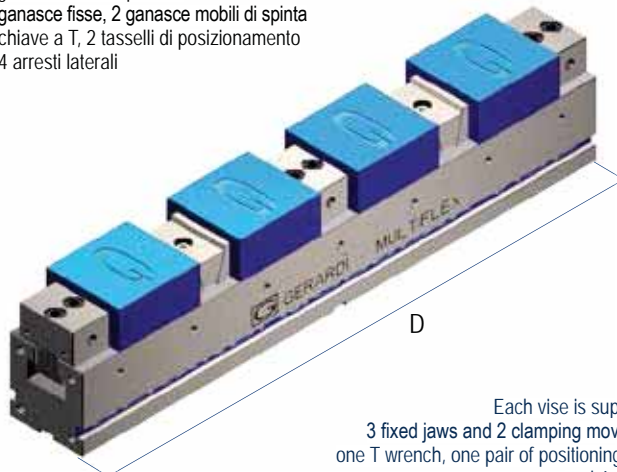

Each vise is supplied with
3 fixed jaws and 2 clamping movable jaws
one T wrench, one pair of positioning key nuts
and 4 workstops

Base Tipo 3 - Base Type 3

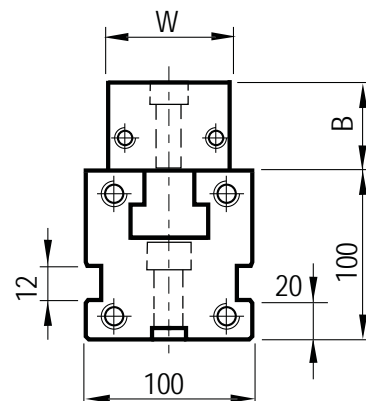

Vedi quota B pag. 6.17 - For dimension B see page 6.17

Quick guide for the proper MULTIFLEX vise choice according to your specific application

kN	GANASCIA Tipo 1 - / JAW Type 1 20 kN				GANASCIA Tipo 2 - / JAW Type 2 30 kN			
	D	700	800	900	1000	700	800	900
W	49				74			
1 pezzo / piece	606	706	806	906	578	678	778	878
2 pezzi / pieces	275	325	375	425	253	303	353	403
3 pezzi / pieces	164,7	198	231,3	264,7	144,7	178	211,3	244,7
4 pezzi / pieces	109,5	134,5	159,5	184,5	90,5	115,5	140,5	165,5
5 pezzi / pieces	76,4	96,4	116,4	136,4	58	78	98	118
6 pezzi / pieces	54,3	71	87,7	104,3	36,3	53	69,7	86,3
7 pezzi / pieces	38,6	52,9	67,1	81,4	20,9	35	49,4	63,7
8 pezzi / pieces	26,8	39,3	51,8	64,3	9,3	21,8	34,3	46,8
9 pezzi / pieces	17,6	28,7	39,8	50,9	-	11,3	22,4	33,6
10 pezzi / pieces	10,2	20,2	30,2	40,2	-	3	13	23
11 pezzi / pieces	4,2	13,3	22,4	31,5	-	-	5,3	14,4
12 pezzi / pieces	-	7,5	15,8	24,2	-	-	-	7,2
13 pezzi / pieces	-	2,6	10,3	18	-	-	-	-
14 pezzi / pieces	-	-	5,6	12,7	-	-	-	-
15 pezzi / pieces	-	-	1,5	8,1	-	-	-	-
Cod. Art. 633	6.63.31700	6.63.31800	6.63.31900	6.63.31100	6.63.32700	6.63.32800	6.63.32900	6.63.32100
Cod. Art. 633S	6.63.3S170	6.63.3S180	6.63.3S190	6.63.3S110	6.63.3S270	6.63.3S280	6.63.3S290	6.63.3S210

Apertura max in relazione al numero dei pezzi
Max opening according to pieces to be clamped

D	700	800	900	1000	700	800	900	1000
	W	49				74		
1 pezzo / piece	596	696	796	896	565	665	765	865
2 pezzi / pieces	265	315	365	415	240	290	340	390
3 pezzi / pieces	154,7	188	221,3	254,7	131,7	165	198,3	231,7
4 pezzi / pieces	99,5	124,5	149,5	174,5	77,5	102,5	127,5	152,5
5 pezzi / pieces	66,4	86,4	106,4	126,4	45	65	85	105
6 pezzi / pieces	44,3	61	77,7	94,3	23,3	40	56,7	73,3
7 pezzi / pieces	28,6	42,9	57,1	71,4	7,9	22,1	36,4	50,7
8 pezzi / pieces	16,8	29,3	41,8	54,3	-	8,8	21,3	33,8
9 pezzi / pieces	7,6	18,7	29,8	40,9	-	-	9,4	20,6
10 pezzi / pieces	-	10,2	20,2	30,2	-	-	-	10
11 pezzi / pieces	-	3,3	12,4	21,5	-	-	-	-
12 pezzi / pieces	-	-	5,8	14,2	-	-	-	-
13 pezzi / pieces	-	-	-	8	-	-	-	-
Cod.	6.65.31700	6.65.31800	6.65.31900	6.65.31100	6.65.32700	6.65.32800	6.65.32900	6.65.32100

Apertura max in relazione al numero dei pezzi
Max opening according to pieces to be clamped

D	700	800	900	1000	700	800	900	1000
	W	49				74		
1 pezzo / piece	577	677	777	877	545	645	745	845
2 pezzi / pieces	288,5	338,5	388,5	438,5	272	322,5	372,5	422,5
3 pezzi / pieces	164	197,3	230,7	264	146,7	180	213	246,7
4 pezzi / pieces	123	148	173	198	110	135	160	185
5 pezzi / pieces	81,4	101,4	121,4	141,4	67	87	107	127
6 pezzi / pieces	67,8	84,5	101,2	117,8	55,8	72,5	89,2	105,8
7 pezzi / pieces	46	60,3	74,6	88,9	32,9	47,1	61,4	75,7
8 pezzi / pieces	40,3	52,8	65,3	77,8	28,8	41,3	53,8	66,3
9 pezzi / pieces	26,3	37,4	48,6	59,7	13,9	25	36,1	47,2
10 pezzi / pieces	23,7	33,7	43,7	53,7	12,5	22,5	32,5	42,5
11 pezzi / pieces	13,8	22,9	32	41,1	-	10,9	20	29,1
12 pezzi / pieces	12,7	21	29,3	37,7	-	10	18,3	26,7
13 pezzi / pieces	5,2	12,8	20,5	28,2	-	-	8,8	16,5
14 pezzi / pieces	1,4	8,6	15,7	22,9	-	-	4,3	11,4
15 pezzi / pieces	-	5,5	12,1	18,8	-	-	-	7,3
16 pezzi / pieces	-	2,2	8,4	14,7	-	-	-	3,4
17 pezzi / pieces	-	-	5,7	11,6	-	-	-	-
18 pezzi / pieces	-	-	-	8,3	-	-	-	-
19 pezzi / pieces	-	-	-	5,9	-	-	-	-
Cod.	6.69.31700	6.69.31800	6.69.31900	6.69.31100	6.69.32700	6.69.32800	6.69.32900	6.69.32100

Apertura max in relazione al numero dei pezzi
Max opening according to pieces to be clamped

Tipo (grandezza) morsa / Vise type (size)

Art. 600

Morsa con ganasce lisce (Art. 605) / Vise with smooth jaws (Art. 605)

Art. 600S

Morsa con ganasce zigrinate (Art. 605S) / Vise with serrated jaws (Art. 605S)

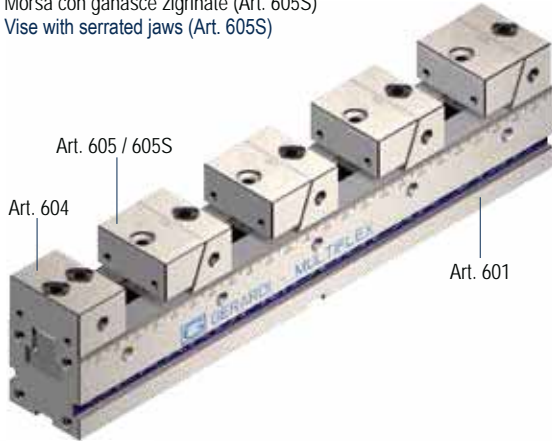

kN	1				
	20 kN				
A	4 x 8mm	4 x 33	4 x 58	4 x 83	4 x 108
B	32 / 25				
C ⁰ / _{-0,02}	50				
D	300	400	500	600	700
G ⁰ / _{-0,02}	50				
J	38				
J1	55 / 58				
I	10				
L	15				
Z	100				
W	49				
Ø P	9				
Q	100	100	300	300	400
Ø F7	10				
kg	7,2	8,7	10,1	11,6	13
Cod. Art. 600	6.60.01300	6.60.01400	6.60.01500	6.60.01600	6.60.01700
Cod. Art. 600S	6.60.0S130	6.60.0S140	6.60.0S150	6.60.0S160	6.60.0S170



AMPLIA LE TUE APPLICAZIONI TRAMITE GLI ACCESSORI MODULARI !

Art. 604

Ganascia fissa
Fixed jaw



Cod. 6.60.41000

Art. 605

Ganascia mobile e fissa liscia
Fixed and movable smooth jaws



Art. 605S

Ganascia mobile e fissa zigrinata
Fixed and movable serrated jaws



Cod. Art.605 6.60.51000

Cod. Art.605S 6.60.5S100

Art. 605L

Cuneo di spinta a "V"
"V" clamping wedge



Cod. 6.60.5L100

Art. 615

Ganascia con cuneo di posizionamento maggiorato
Jaw with bigger positioning wedge
(increased with respect to standard dimensions)



Cod. 6.61.51000

Art. 600 / Art. 600S

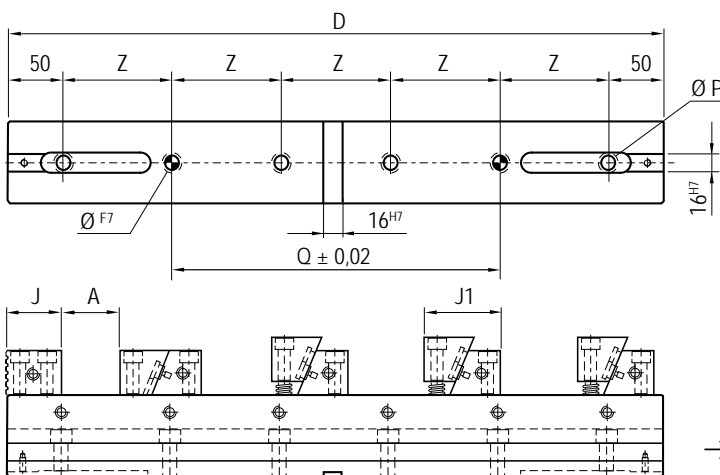

Ogni morsa è completa di 1 ganascia fissa, 4 ganasce fisse-mobili
1 chiave a T, 2 tasselli di posizionamento e 4 arresti laterali
Each vise is supplied with 1 fixed jaw and 4 fixed-movable jaws
1 T wrench, one pair of positioning key nuts and 4 workstops

Ø = Sede viti calibrate / Hole for calibrated screw

Art.81	Tipo - Type 1	Ø10h7 x 20
Art.81	Tipo - Type 2	Ø16h7 x 35
Art.81	Tipo - Type 3	Ø16h7 x 45

Vedi pag. 6.34 - Vedi page 6.34

Art. 600	Art. 600S	Pag.
n° 1 Art. 601		6.26
n° 1 Art. 604		6.28
n° 4 Art. 605	n° 4 Art. 605S	6.29

	2 30 kN						3 40 kN			
	4 x 12mm	4 x 37	4 x 62	4 x 87	4 x 112	4x137	4 x 59	4 x 84	4 x 109	4 x 134
A										
B	40						60			
C ⁰ _{-0,02}	75						100			
D	400	500	600	700	800	900	700	800	900	1000
G ⁰ _{-0,02}	75						100			
J	50						70			
J1	70 / 75						94,5 / 98,5			
I	16						12			
L	20						20			
Z	100						100			
W	74						99			
P	13						17			
Q	300	200	300	400	500	400	400	500	400	500
Ø F7	16						16			
kg	22,45	25,95	29,45	32,95	36,4	39,9	65,1	70,6	77,6	83,3
Cod. Art. 600	6.60.02400	6.60.02500	6.60.02600	6.60.02700	6.60.02800	6.60.02900	6.60.03700	6.60.03800	6.60.03900	6.60.03100
Cod. Art. 600S	6.60.0S240	6.60.0S250	6.60.0S260	6.60.0S270	6.60.0S280	6.60.0S290	6.60.0S370	6.60.0S380	6.60.0S390	6.60.0S310

UPGRADE YOUR VISE APPLICATIONS THROUGH MODULAR ACCESSORIES !

Cod.	6.60.42000	6.60.43000
Cod. Art.605	6.60.52000	6.60.53000
Cod. Art.605S	6.60.5S200	6.60.5S300
Cod.	6.60.5L200	6.60.5L300
Cod.	6.61.52000	6.61.53000

Art. 605

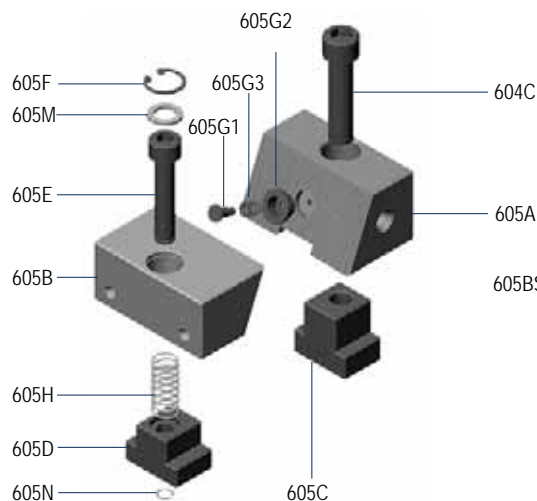

Art. 605S

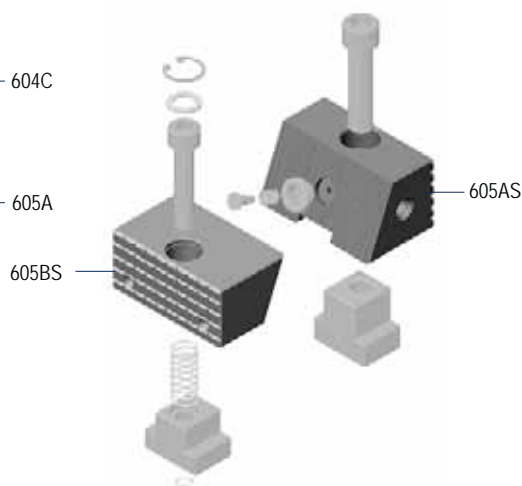

Art. Pag.

605A	
605AS	
605B	
605BS	
604C	
605C	
605D	
605E	6.31
605F	
605G1	
605G2	
605G3	
605H	
605M	
605N	

Tipo (grandezza) morsa / Vise type (size)

Art. 606

Morsa con ganasce a gradino (Art. 609) / Vise with step jaws (Art. 609)

Art. 606T NEW

Morsa con ganascia **GRIP** (Art. 609T) / Vise with **GRIP** jaws (Art. 609T)

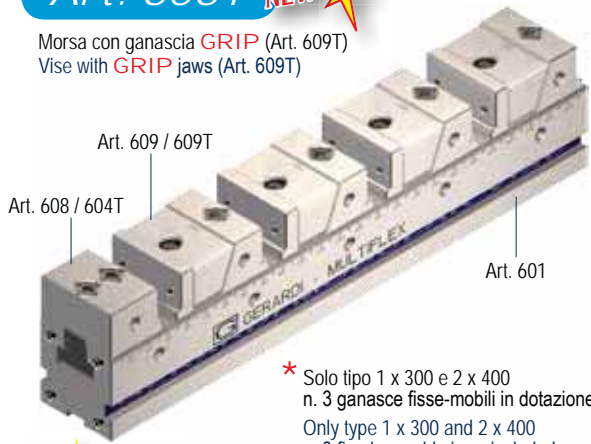

* Solo tipo 1 x 300 e 2 x 400
n. 3 ganasce fisse-mobili in dotazione
Only type 1 x 300 and 2 x 400
n. 3 fixed-movable jaws included

kN	1				
	20 kN				
A	3 x 19mm *	4 x 23	4 x 48	4 x 73	4 x 97
B	32 / 25				
C ⁰ _{-0,02}	50				
D	300	400	500	600	700
G ⁰ _{-0,02}	50				
J	38				
J1	65 / 68				
I	12				
L	15				
Z	100				
W	49				
Ø P	9				
Q	100	100	300	300	400
Ø F7	10				
kg	7,25	8,8	10,2	11,7	13,15
Cod. Art. 606	6.60.61300	6.60.61400	6.60.61500	6.60.61600	6.60.61700
Cod. Art. 606T	6.60.6T130	6.60.6T140	6.60.6T150	6.60.6T160	6.60.6T170

AMPLIA LE TUE APPLICAZIONI TRAMITE GLI ACCESSORI MODULARI !

Art. 609

Ganascia fissa e mobile con gradino / Fixed and moving jaw with step



Cod.	6.60.91000
------	------------

Art. 610B *

Piastra ganascia dolce / Soft jaw plate

Art. 610C *

Piastra ganascia liscia / Smooth jaw plate

Art. 610D *

Piastra ganascia zigrinata / Serrated jaw plate

Art. 610E *

Piastra ganascia parallela / Parallel jaw plate

Art. 610F *

Piastra ganascia prismatica / Prismatic jaw plate



Cod. Art. 610B	6.61.0B100
Cod. Art. 610C	6.61.0C100
Cod. Art. 610D	6.61.0D100
Cod. Art. 610E	6.61.0E100
Cod. Art. 610F	6.61.0F1000

* Piastrine Art.610B - 610C - 610D - 610E - 610F dimensioni come pagina 6.32 - Jaw plates Art.610B - 610C - 610E - 610F dimensions as page 6.32

Art. 609T

Ganascia fissa e mobile con piastra ganascia **GRIP** a forte serraggio / Fixed and moving jaw with **GRIP** jaw-plates for strongest clamping



Cod.	6.60.9T100
------	------------

Art. 606 / 606T

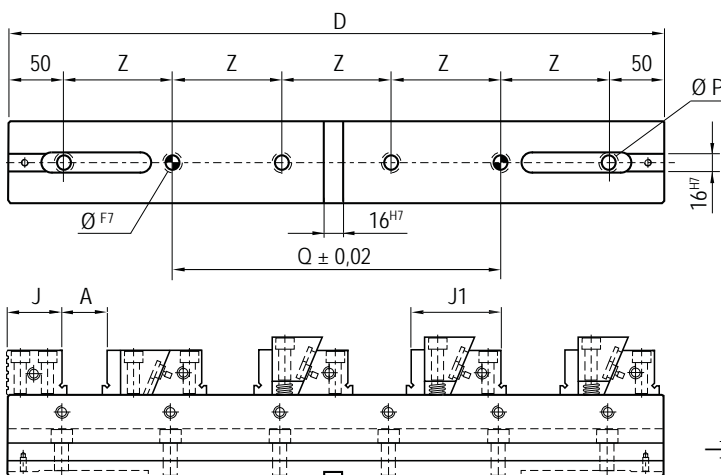

Ogni morsa è completa di 1 ganascia fissa, 4 ganasce fisse-mobili
1 chiave a T, 2 tasselli di posizionamento e 4 arresti laterali
Each vise is supplied with 1 fixed jaw and 4 fixed-movable jaws
1 T wrench, one pair of positioning key nuts and 4 workstops

Ø = Sede viti calibrate / Hole for calibrated screw

Art.81	Tipo - Type 1	Ø10h7 x 20
Art.81	Tipo - Type 2	Ø16h7 x 35
Art.81	Tipo - Type 3	Ø16h7 x 45

Vedi pag. 6.34 - Vedi page 6.34

Art. 606	Art. 606T	Pag.
n° 1 Art. 601		6.26
n° 1 Art. 608 / 604T		6.28
n° 4 Art. 609	n° 4 Art. 609T	6.29

	2 30 kN						3 40 kN			
	A	3 x 28mm*	4 x 24	4 x 49	4 x 74	4 x 99	4x124	4 x 44	4 x 69	4 x 94
B	40						60			
C ⁻⁰ _{-0.02}	75						100			
D	400	500	600	700	800	900	700	800	900	1000
G ⁻⁰ _{-0.02}	75						100			
J	50						70			
J1	83 / 88						109 / 113			
I	16						12			
L	20						20			
Z	100						100			
W	74						99			
P	13						17			
Q	300	200	300	400	500	400	400	500	400	500
Ø F7	16						16			
kg	21,9	25,4	28,9	32,4	38,1	41,6	68,3	73,8	81	86,5
Cod. Art. 606	6.60.62400	6.60.62500	6.60.62600	6.60.62700	6.60.62800	6.60.62900	6.60.63700	6.60.63800	6.60.63900	6.60.63100
Cod. Art. 606T	6.60.6T240	6.60.6T250	6.60.6T260	6.60.6T270	6.60.6T280	6.60.6T290	6.60.6T370	6.60.6T380	6.60.6T390	6.60.6T310

UPGRADE YOUR VISE APPLICATIONS THROUGH MODULAR ACCESSORIES !

Cod.	6.60.92000	6.60.93000
------	------------	------------

Cod. Art. 610B	6.61.0B200	6.61.0B300
Cod. Art. 610C	6.61.0C200	6.61.0C300
Cod. Art. 610D	6.61.0D200	6.61.0D300
Cod. Art. 610E	6.61.0E200	6.61.0E300
Cod. Art. 610F	6.61.0F200	6.61.0F300

* Piastrine Art.610B - 610C - 610D - 610E - 610F dimensioni come pagina 6.32 - Jaw plates Art.610B - 610C - 610E - 610F dimensions as page 6.32

Cod.	6.60.9T200	6.60.9T300
------	------------	------------

Art. 609

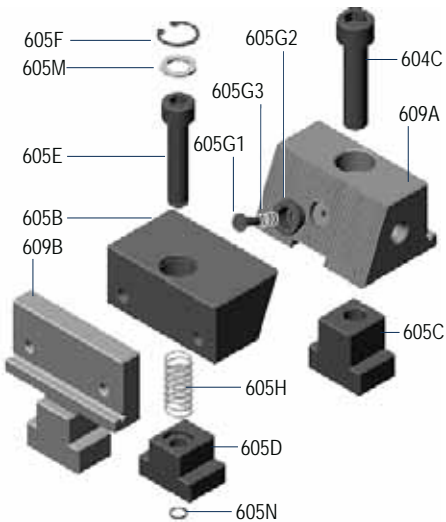

Art. 609T

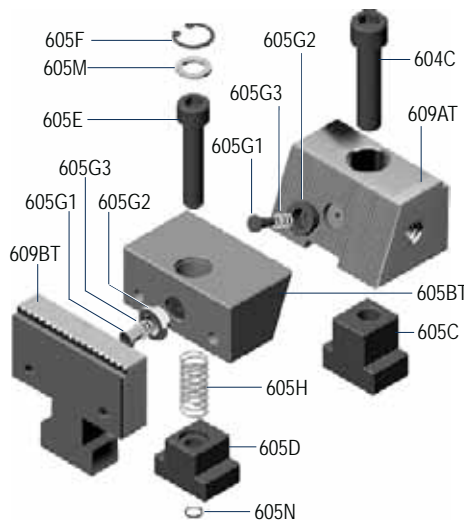

Art.	Pag.	Art.	Pag.
604C		605H	6.31
605B		605M	6.31
605BT		605N	6.31
605C		609A	6.32
605D	6.31	609B	6.32
605E		609AT	6.32
605F		609BT	6.32
605G1		-	-
605G2		-	-
605G3		-	-

Tipo (grandezza) morsa / Vise type (size)

Art. 611

Morsa con ganasce doppie (Art. 613)
Vise with double jaws (Art. 613)

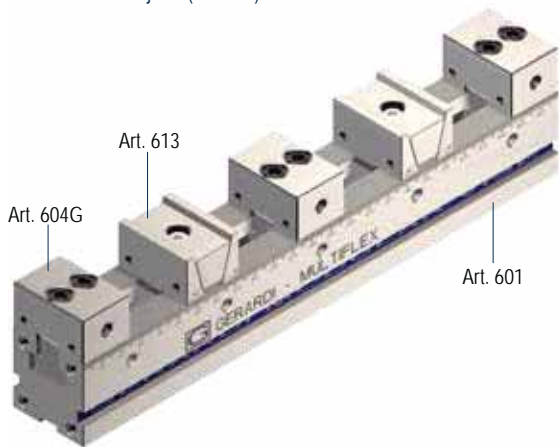

kN	1				
	20 kN				
A	4 x 21mm	4 x 46	4 x 71	4 x 94	4 x 121
B	25				
C ⁰ _{-0,02}	50				
D	300	400	500	600	700
G ⁰ _{-0,02}	50				
J	38				
J1	44 / 50				
I	12				
L	15				
Z	100				
W	49				
Ø P	9				
Q	100	100	300	300	400
Ø F7	10				
kg	6,6	8,1	9,5	11	12,5
Cod.	6.61.11300	6.61.11400	6.61.11500	6.61.11600	6.61.11700



AMPLIA LE TUE APPLICAZIONI TRAMITE GLI ACCESSORI MODULARI !

Art. 604G

Ganascia fissa liscia da entrambi i lati
Fixed smooth jaws both sides



Cod. 6.60.4G100

Art. 610B *

Piastra ganascia dolce / Soft jaw plate



Cod. Art. 610B 6.61.0B100

Art. 610C *

Piastra ganascia liscia / Smooth jaw plate



Cod. Art. 610C 6.61.0C100

Art. 610D *

Piastra ganascia zigrinata / Serrated jaw plate



Cod. Art. 610D 6.61.0D100

Art. 610E *

Piastra ganascia parallela / Parallel jaw plate



Cod. Art. 610E 6.61.0E100

Art. 610F *

Piastra ganascia prismatica / Prismatic jaw plate



Cod. Art. 610F 6.61.0F1000

* Piastrine Art.610B - 610C - 610D - 610E - 610F dimensioni come pagina 6.32 - Jaw plates Art.610B - 610C - 610E - 610F dimensions as page 6.32

Art. 613

Ganascia mobile di spinta
lamping movable jaws



Cod. 6.61.31000

Art. 611

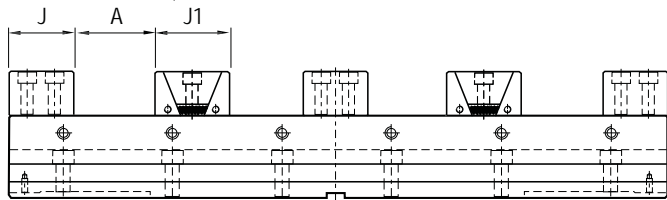
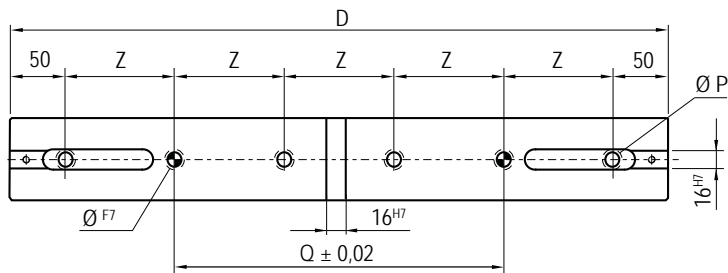

Ogni morsa è completa di 1 ganascia fissa, 4 ganasce fisse-mobili
1 chiave a T, 2 tasselli di posizionamento e 4 arresti laterali
Each vise is supplied with 1 fixed jaw and 4 fixed-movable jaws
1 T wrench, one pair of positioning key nuts and 4 workstops

Ø = Sede viti calibrate / Hole for calibrated screw

Art.81	Tipo - Type 1	Ø10h7 x 20
Art.81	Tipo - Type 2	Ø16h7 x 35
Art.81	Tipo - Type 3	Ø16h7 x 45

Vedi pag. 6.34 - Vedi page 6.34

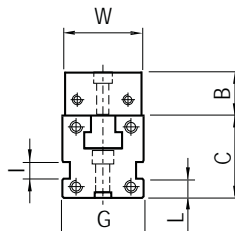

Art. 611	Pag.
n° 1 Art. 601	6.26
n° 3 Art. 604G	6.15
n° 2 Art. 613	6.15

	2 30 kN						3 40 kN			
	4 x 34	4 x 59	4 x 84	4 x 109	4 x 134	4x159	4 x 77	4 x 102	4 x 127	4 x 152
A										
B	40						60			
C ⁻⁰ _{-0,02}	75						100			
D	400	500	600	700	800	900	700	800	900	1000
G ⁻⁰ _{-0,02}	75						100			
J	50						70			
J1	52 / 58						84 / 90			
I	16						12			
L	20						20			
Z	100						100			
W	74						99			
P	13						17			
Q	300	200	300	400	500	400	400	500	400	500
Ø F7	16						16			
kg	20,79	24,29	27,79	31,29	34,8	38,3	63	68,5	74	79,5
Cod.	6.61.12400	6.61.12500	6.61.12600	6.61.12700	6.61.12800	6.61.12900	6.61.13700	6.61.13800	6.61.13900	6.61.13100

UPGRADE YOUR VISE APPLICATIONS THROUGH MODULAR ACCESSORIES !

Cod.	6.60.4G200	6.60.4G300
Cod. Art. 610B	6.61.0B200	6.61.0B300
Cod. Art. 610C	6.61.0C200	6.61.0C300
Cod. Art. 610D	6.61.0D200	6.61.0D300
Cod. Art. 610E	6.61.0E200	6.61.0E300
Cod. Art. 610F	6.61.0F200	6.61.0F300

* Piastrine Art.610B - 610C - 610D - 610E - 610F dimensioni come pagina 6.32 - Jaw plates Art.610B - 610C - 610E - 610F dimensions as page 6.32

Cod.	6.61.32000	6.61.33000
------	------------	------------

Art. 604G

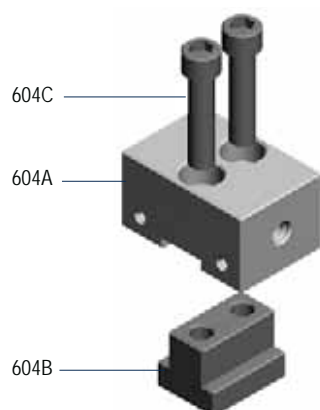

Art. 613

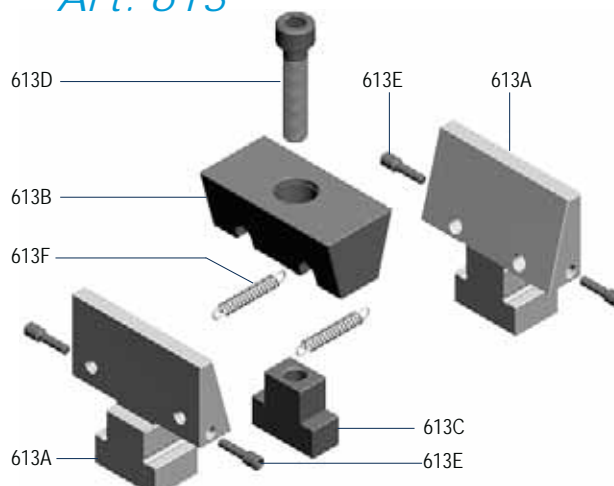

Art.	Pag.
604A	6.31
604B	6.31
604C	6.31
613A	6.33
613B	6.33
613C	6.33
613D	6.33
613E	6.33
613F	6.33
-	-

Tipo (grandezza) **GANASCIA / JAW** type (size)

Art. 632

Morsa con ganasce lisce (Art. 605)
Vise with smooth jaws (Art. 605)

Art. 632S

Morsa con ganasce zigrinate (Art. 605S)
Vise with serrated jaws (Art. 605S)

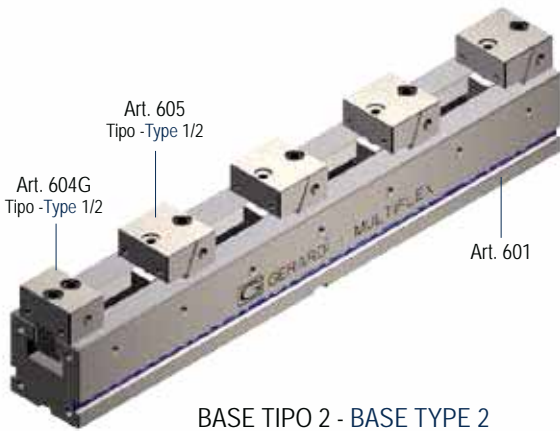

BASE TIPO 2 - BASE TYPE 2
Ganasce Tipo 1 - Jaws Type 1

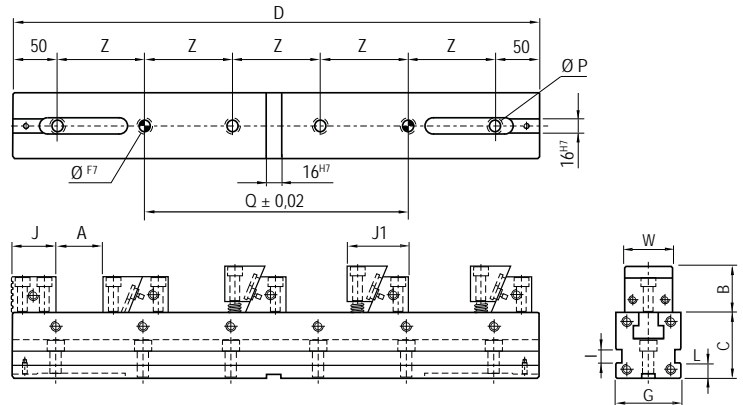

Vedi pag 6.34 - See pag 6.34



Art. 652

Morsa con ganasce a gradino (Art. 609)
Vise with step jaws (Art. 609)

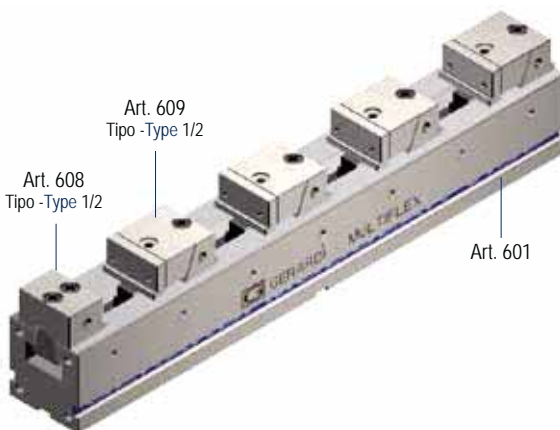

BASE TIPO 2 - BASE TYPE 2
Ganasce Tipo 1 - Jaws Type 1

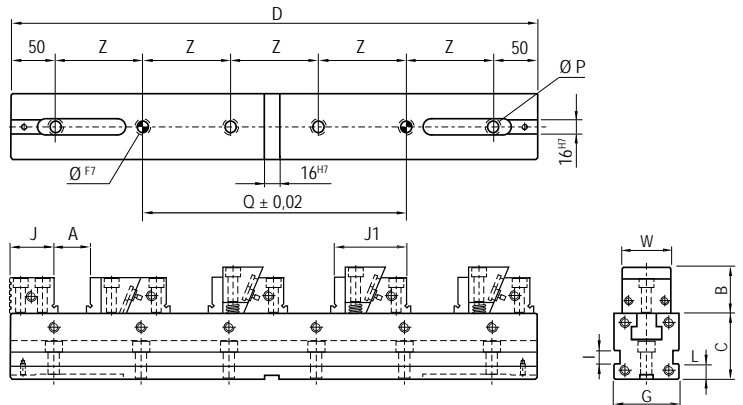

Vedi pag 6.34 - See pag 6.34



Art. 692

Morsa con ganasce doppie (Art. 613)
Vise with double jaws (Art. 613)

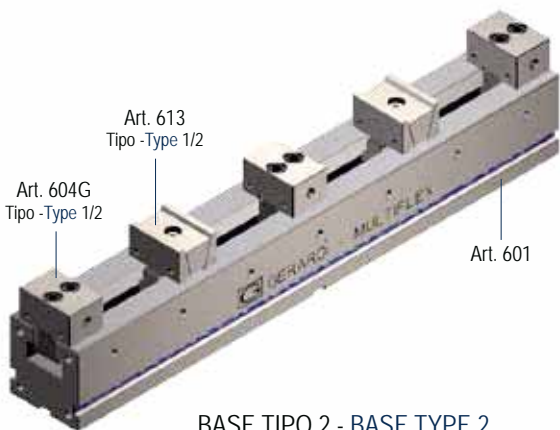

BASE TIPO 2 - BASE TYPE 2
Ganasce Tipo 1 - Jaws Type 1

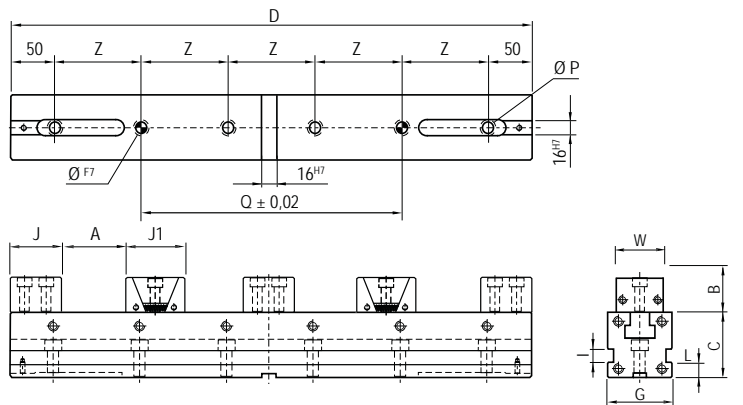

Vedi pag 6.34 - See pag 6.34



kN	1 20 kN					
	A	4 x 32,5	4 x 57,5	4 x 82,5	4 x 107,5	4 x 132,5
B	32 / 25					
C ⁻⁰ _{-0,02}	75					
D	400	500	600	700	800	900
G ⁻⁰ _{-0,02}	75					
J	38					
J1	55 / 58					
I	16					
L	20					
Z	100					
W	49					
ØP	13					
Q	300	200	300	400	500	400
Ø ^{F7}	16					
kg	16,7	20,2	23,7	27,2	30,7	34,2
Cod. Art. 632	6.63.21400	6.63.21500	6.63.21600	6.63.21700	6.63.21800	6.63.21900
Cod. Art. 632S	6.63.2S140	6.63.2S150	6.63.2S160	6.63.2S170	6.63.2S180	6.63.2S190

A	4 x 24,5	4 x 49,5	4 x 74,5	4 x 99,5	4 x 124,5	4 x 149,5
B	32 / 25					
C	75					
D	400	500	600	700	800	900
G ⁻⁰ _{-0,02}	75					
J	38					
J1 ⁻⁰ _{-0,02}	65 / 68					
I	16					
L	20					
Z	100					
W	49					
ØP	13					
Q	300	200	300	400	500	400
Ø ^{F7}	16					
kg	16,8	20,3	23,8	27,3	30,8	34,3
Cod.	6.65.21400	6.65.21500	6.65.21600	6.65.21700	6.65.21800	6.65.21900

A	4 x 48	4 x 73	4 x 98	4 x 123	4 x 148	4 x 173
B	25					
C	75					
D	400	500	600	700	800	900
G ⁻⁰ _{-0,02}	75					
J	38					
J1 ⁻⁰ _{-0,02}	44 / 50					
I	16					
L	20					
Z	100					
W	49					
ØP	13					
Q	300	200	300	400	500	400
Ø ^{F7}	16					
kg	16,1	19,6	23,1	26,6	30,1	33,7
Cod.	6.69.21400	6.69.21500	6.69.21600	6.69.21700	6.69.21800	6.69.21900

Tipo (grandezza) **GANASCIA / JAW** type (size)

Art. 633

Morsa con ganasce lisce (Art. 605)
Vise with smooth jaws (Art. 605)

Art. 633S

Morsa con ganasce zigrinate (Art. 605S)
Vise with serrated jaws (Art. 605S)

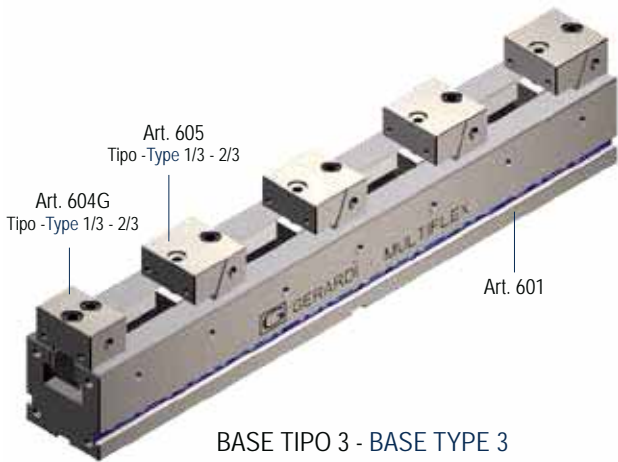

BASE TIPO 3 - BASE TYPE 3
Ganasce Tipo 1 o 2 - Jaws Type 1 or 2

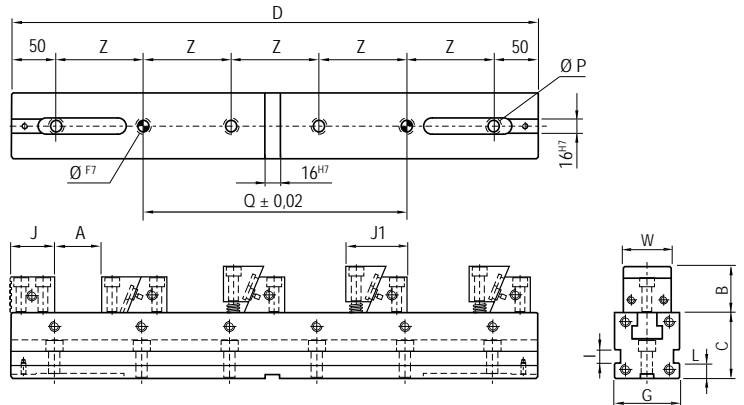

Vedi pag 6.34 - See pag 6.34



Art. 653

Morsa con ganasce a gradino (Art. 609)
Vise with step jaws (Art. 609)

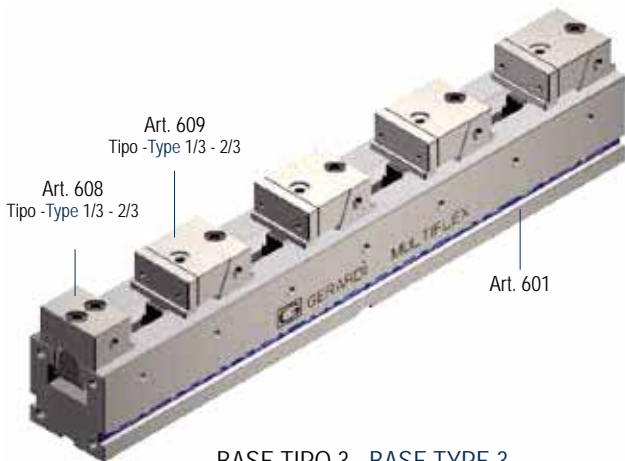

BASE TIPO 3 - BASE TYPE 3
Ganasce Tipo 1 o 2 - Jaws Type 1 or 2

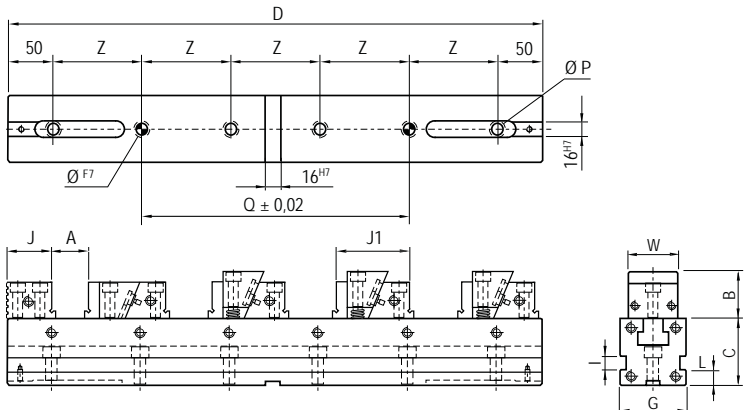

Vedi pag 6.34 - See pag 6.34



Art. 693

Morsa con ganasce doppie (Art. 613)
Vise with double jaws (Art. 613)

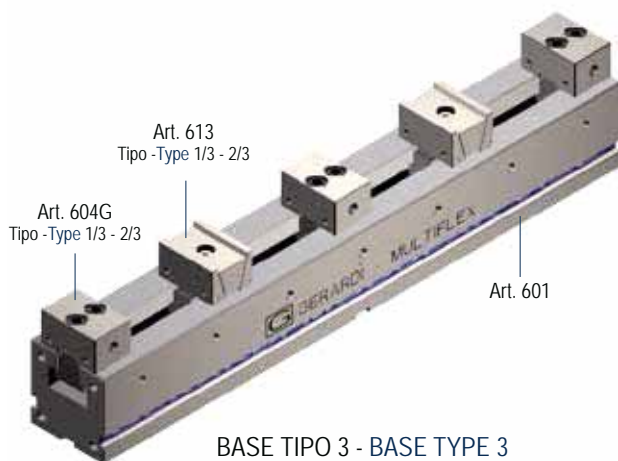

BASE TIPO 3 - BASE TYPE 3
Ganasce Tipo 1 o 2 - Jaws Type 1 or 2

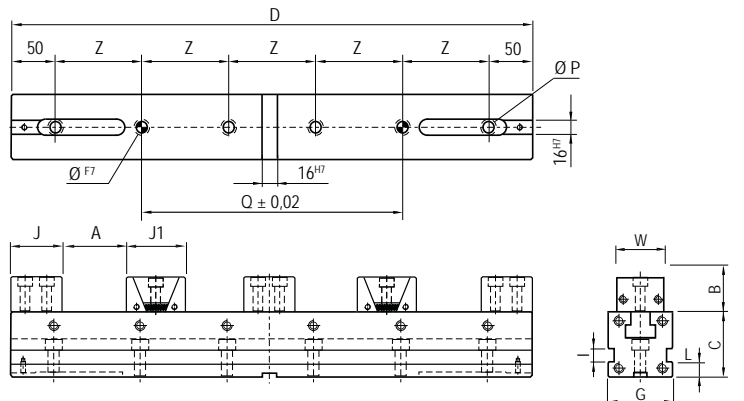

Vedi pag 6.34 - See pag 6.34



kN	1 20 kN				2 30 kN			
	A	4 x 109,5	4 x 134,5	4 x 159,5	4 x 184,5	4 x 90,5	4 x 115,5	4 x 140,5
B	32 / 25				40			
C ^{-0,02}	100				100			
D	700	800	900	1000	700	800	900	1000
G ^{-0,02}	100				100			
J	38				50			
J1	55 / 58				70 / 25			
I	12				12			
L	20				20			
Z	100				100			
W	49				74			
P	17				17			
Q	400	500	400	500	400	500	400	500
Ø ^{F7}	16				16			
kg	45,3	50,8	57,8	63,5	50,5	56	63	68,7
Cod. Art. 633	6.63.31700	6.63.31800	6.63.31900	6.63.31100	6.63.32700	6.63.32800	6.63.32900	6.63.32100
Cod. Art. 633S	6.63.3S170	6.63.3S180	6.63.3S190	6.63.3S110	6.63.3S270	6.63.3S280	6.63.3S290	6.63.3S210

A	4 x 99,5	4 x 124,5	4 x 149,5	4 x 174,5	4 x 77,5	4 x 102,5	4 x 127,5	4 x 152,5
B	32 / 25				40			
C	100				100			
D	700	800	900	1000	700	800	900	1000
G ^{-0,02}	100				100			
J	38				50			
J1 ^{-0,02}	65 / 68				83 / 88			
I	12				12			
L	20				20			
Z	100				100			
W	49				74			
P	17				17			
Q	400	500	400	500	400	500	400	500
Ø ^{F7}	16				16			
kg	45,4	50,9	57,9	63,6	51,1	56,6	63,6	69,3
Cod.	6.65.31700	6.65.31800	6.65.31900	6.65.31100	6.65.32700	6.65.32800	6.65.32900	6.65.32100

A	4 x 123	4 x 148	4 x 173	4 x 198	4 x 110	4 x 135	4 x 160	4 x 185
B	25				40			
C	100				100			
D	700	800	900	1000	700	800	900	1000
G ^{-0,02}	100				100			
J	38				50			
J1 ^{-0,02}	44 / 50				52 / 58			
I	12				12			
L	20				20			
Z	100				100			
W	49				74			
P	17				17			
Q	400	500	400	500	400	500	400	500
Ø ^{F7}	16				16			
kg	44,7	50,2	57,9	62,9	49,4	54,9	61,9	66,6
Cod.	6.69.31700	6.69.31800	6.69.31900	6.69.31100	6.69.32700	6.69.32800	6.69.32900	6.69.32100



Tipo (grandezza) morsa / Vise type (size)

kN

1

20 kN

Art. 602

Cubo-morsa con ganasce lisce (Art. 605)
Vise-tower with smooth jaws (Art. 605)

Art. 602S

Cubo-morsa con ganasce zigrinate (Art. 605S)
Vise-tower with serrated jaws (Art. 605S)

Ogni cubo-morsa è completo di
4 ganasce fisse, 16 ganasce fisse mobili,
1 chiave a T, 1 coppia tasselli di posizionamento
e 16 arresti laterali

Each vise-tower is supplied with
4 fixed jaws and 16 fixed-movable jaws
1 T wrench, 1 pair of positioning
key nuts and 16 workstops



Art. 828 extra

	1 20 kN				
A	4 x 8mm	4 x 33	4 x 58	4 x 83	4 x 108
B	25				
B1	32 / 25				
C ⁻⁰ _{-0,02}	100				
D	300	400	500	600	700
G ⁻⁰ _{-0,02}	50				
J	38				
J1	55 / 58				
H	66				
Ø I ^{H7}	25				
L	20				
M	14				
kg	26,2	31,2	36,2	41,2	46,3
Cod.	6.60.21300	6.60.21400	6.60.21500	6.60.21600	6.60.21700
Cod.	6.60.2S130	6.60.2S140	6.60.2S150	6.60.2S160	6.60.2S170



AMPLIA LE TUE APPLICAZIONI TRAMITE GLI ACCESSORI MODULARI !

Art. 604

Ganascia fissa
Fixed jaw



Cod. 6.60.41000

Art. 605

Ganascia mobile
e fissa liscia
Fixed and movable
smooth jaws



Art. 605S

Ganascia mobile
e fissa zigrinata
Fixed and movable
serrated jaws



Cod. Art.605 6.60.51000

Cod. Art.605S 6.60.5S100

Art. 605L

Cuneo di spinta a "V"
"V" clamping wedge



Cod. 6.60.5L100

Art. 615

Ganascia con cuneo di posizionamento maggiorato
Jaw with bigger positioning wedge
(increased with respect to standard dimensions)



Cod. 6.61.51000

Art. 602 / Art. 602S

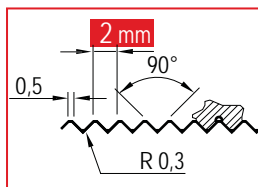

2 mm = Passo delle righe
Rows pitch

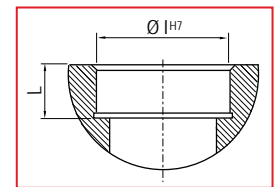

Foro di centraggio
Centering hole

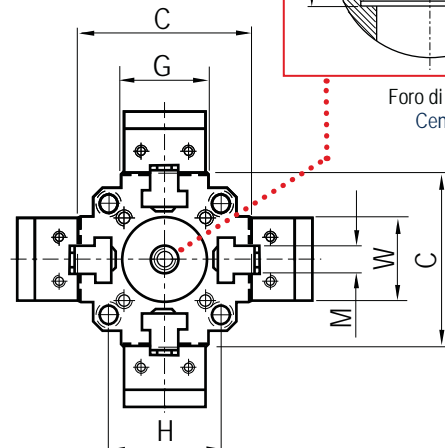
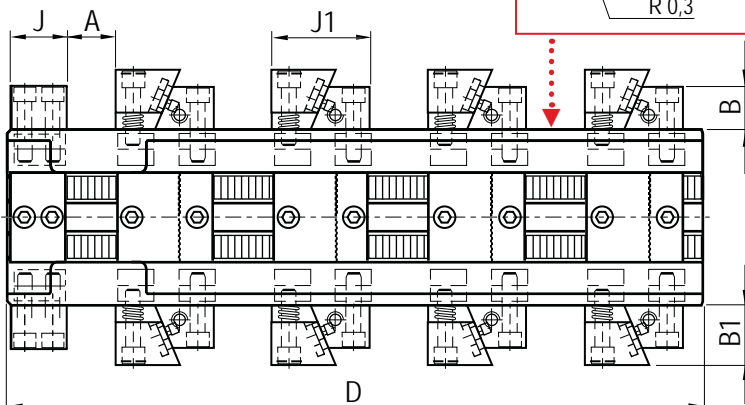

2 30 kN							3 40 kN				
4 x 12mm	4 x 37	4 x 62	4 x 62	4 x 87	4 x 87	4 x 87	4 x 112	4 x 59	4 x 84	4 x 109	4 x 134
	40		40	40		40			60		
	40		40	40		40			60		
	150		230	150	210	240			240		
400	500	600	600	700	700	700	800	700	800	900	1000
	75		75	75		75			100		
	50		50	50		50			70		
	70 / 75		70 / 75	70 / 75		70 / 75			94,5 / 98,5		
	100		-	100	100	-	-		150 / 200		
	50		50	50		50			50		
	20		20	20		20			20		
	22		22	22		22			30		
79	90,2	101,4	144	112,6	149,2	175	195	254	278	301	325
6.60.22400	6.60.22500	6.60.22600	6.60.22601	6.60.22700	6.60.22701	6.60.22702	6.60.22800	6.60.23700	6.60.23800	6.60.23900	6.60.23100
6.60.2S240	6.60.2S250	6.60.2S260	6.60.2S261	6.60.2S270	6.60.2S271	6.60.2S272	6.60.2S280	6.60.2S370	6.60.2S380	6.60.2S390	6.60.2S310

I prezzi su fondo rosso sono comprensivi di base integrale / Prices on the red background include the solid head plate with the vise-tower

UPGRADE YOUR VISE APPLICATIONS THROUGH MODULAR ACCESSORIES !

6.60.42000

6.60.43000

6.60.52000

6.60.53000

6.60.5S200

6.60.5S300

6.60.5L200

6.60.5L300

6.61.52000

6.61.53000

Art. 602 / Art. 602S

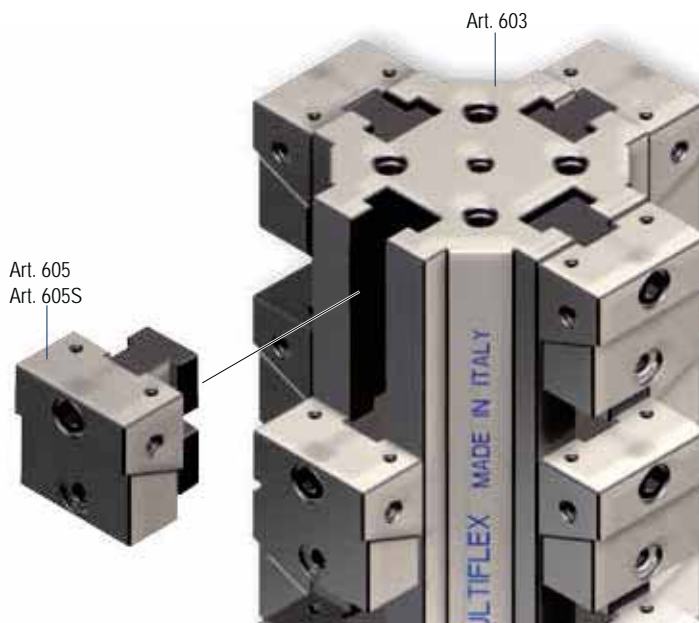

Art. 602	Art. 602S	Pag.
n° 1 Art. 603		6.27
n° 4 Art. 604		6.28
n° 16 Art. 605	n° 16 Art. 605S	6.29

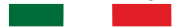

Tipo (grandezza) morsa / Vise type (size)

kN

1

20 kN

Art. 607

Cubo-morsa con ganasce a gradino (Art. 609)
Vise-tower with step jaws (Art. 609)

Art. 607T NEW

Cubo-morsa con ganasce **GRIP** (Art. 609T)
Vise-tower with **GRIP** jaws (Art. 609T)

Ogni cubo-morsa è completo di
4 ganasce fisse, 16 ganasce fisse mobili,
1 chiave a T, 1 coppia tasselli di posizionamento
e 16 arresti laterali

Each vise-tower is supplied with
4 fixed jaws and 16 fixed-movable jaws
1 T wrench, 1 pair of positioning key nuts
and 16 workstops

* Solo tipo 1x300 e 2x400 n. 12 ganasce fisse-mobili in dotazione
Only type 1x300 and 2x400 n. 3 fixed-movable
jaws included



Art. 828 extra

	3 x 19mm *	4 x 23	4 x 48	4 x 73	4 x 97
A					
B				25	
B1				32 / 25	
C ^{-0,02}				100	
D	300	400	500	600	700
G ^{-0,02}				50	
J				38	
J1				65 / 68	
H				66	
Ø I ^{H7}				25	
L				20	
M				14	
W				49	
kg	29,6	34,6	39,6	44,6	49,7
Cod. Art. 607	6.60.71300	6.60.71400	6.60.71500	6.60.71600	6.60.71700
Cod. Art. 607T	6.60.7T130	6.60.7T140	6.60.7T150	6.60.7T160	6.60.7T170



AMPLIA LE TUE APPLICAZIONI TRAMITE GLI ACCESSORI MODULARI !

Art. 609

Ganascia fissa e mobile con gradino
Fixed and moving jaw with step



Cod. 6.60.91000

Art. 610B *

Piastra ganascia dolce / Soft jaw plate

Cod. Art. 610B 6.61.0B100

Art. 610C *

Piastra ganascia liscia / Smooth jaw plate

Cod. Art. 610C 6.61.0C100

Art. 610D *

Piastra ganascia zigrinata / Serrated jaw plate

Cod. Art. 610D 6.61.0D100

Art. 610E *

Piastra ganascia parallela / Parallel jaw plate

Cod. Art. 610E 6.61.0E100

Art. 610F *

Piastra ganascia prismatica / Prismatic jaw plate

Cod. Art. 610F 6.61.0F1000

* Piastrine Art.610B - 610C - 610D - 610E - 610F dimensioni come pagina 6.32 - Jaw plates Art.610B - 610C - 610E - 610F dimensions as page 6.32

Art. 609T

Ganascia fissa e mobile con piastra ganascia **GRIP** a forte serraggio
Fixed and moving jaw with **GRIP** jaw-plates for strongest clamping



Cod. 6.60.9T100

Art. 607

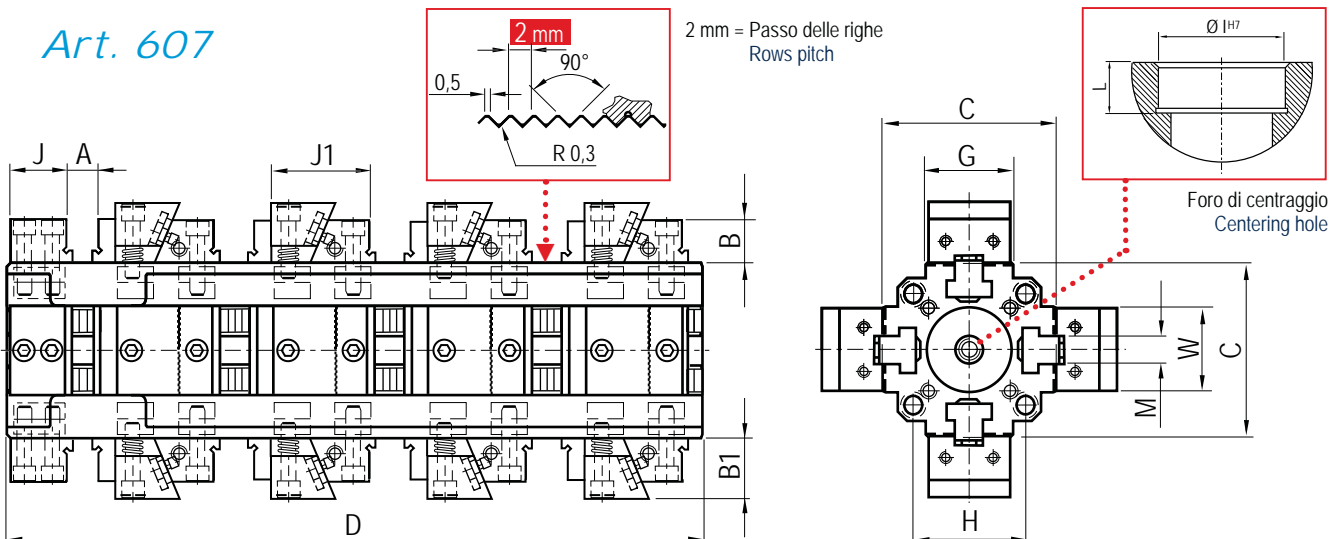

2 30 kN							3 40 kN				
3 x 28mm *	4 x 24	4 x 49	4 x 49	4 x 74	4 x 74	4 x 74	4 x 99	4 x 77	4 x 69	4 x 94	4 x 119
	40		40	40		40			60		
	40		40	40		40			60		
	150		230	150	210	240			240		
400	500	600	600	700	700	700	800	700	800	900	1000
	75		75	75		75			100		
	50		50	50		50			70		
	83 / 88		83 / 88	83 / 88		83 / 88			109 / 113		
	100		-	100	-	-	-		150 / 200		
	50		50	50		50			50		
	20		20	20		20			20		
	22		22	22		22			30		
	74		74	74		74			99		
85,6	96,8	108	150	119,2	155,8	183	203	268	292	315	339
6.60.72400	6.60.72500	6.60.72600	6.60.72601	6.60.72700	6.60.72701	6.60.72702	6.60.72800	6.60.73700	6.60.73800	6.60.73900	6.60.73100
6.60.7T240	6.60.7T250	6.60.7T260	6.60.7T261	6.60.7T270	6.60.7T271	6.60.7T272	6.60.7T280	6.60.7T370	6.60.7T380	6.60.7T390	6.60.7T310

I prezzi su fondo rosso sono **comprensivi di base integrale** / Prices on the red background include the solid head plate with the vise-tower

UPGRADE YOUR VISE APPLICATIONS THROUGH MODULAR ACCESSORIES !

6.60.92000

6.60.93000

6.61.0B200

6.61.0B300

6.61.0C200

6.61.0C300

6.61.0D200

6.61.0D300

6.61.0E200

6.61.0E300

6.61.0F200

6.61.0F300

* Piastrine Art.610B - 610C - 610D - 610E - 610F dimensioni come pagina 6.32 - Jaw plates Art.610B - 610C - 610E - 610F dimensions as page 6.32

6.60.9T200

6.60.9T300

Art. 607

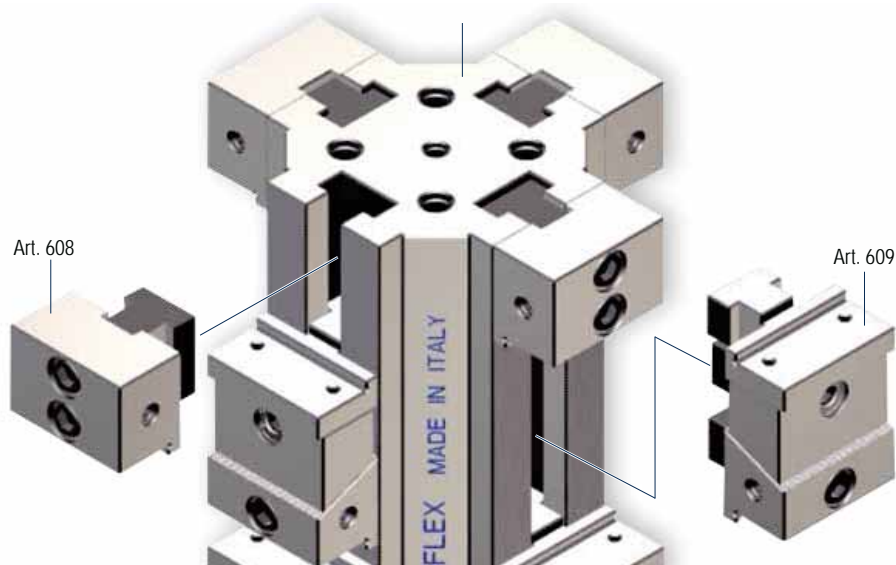

Art. 607	Pag.
n° 1 Art. 603	6.27
n° 4 Art. 608	6.28
n° 16 Art. 609	6.29



Tipo (grandezza) morsa / Vise (type) size

1
20 kN

Art. 612

Cubo-morsa con ganasce doppie (Art. 613)
Vise-tower with double jaws (Art. 613)

Ogni cubo-morsa è completo di
12 ganasce fisse, 8 ganasce fisse mobili,
1 chiave a T,
1 coppia tasselli di posizionamento
e 16 arresti laterali

Each vise-tower is supplied with
12 fixed jaws and 8 fixed-movable jaws
1 T wrench,
1 pair of positioning key nuts
and 16 workstops



A	4 x 21mm	4 x 46	4 x 71	4 x 94	4 x 121
B	25				
C ^{-0,02}	100				
D	300	400	500	600	700
G ^{-0,02}	50				
J	38				
J1	44 / 50				
H	66				
Ø I ^{H7}	50				
L	20				
M	14				
W	49				
kg	24,2	29,3	34,4	39,5	44,5
Cod.	6.61.21300	6.61.21400	6.61.21500	6.61.21600	6.61.21700



AMPLIA LE TUE APPLICAZIONI TRAMITE GLI ACCESSORI MODULARI !

Art. 604G

Ganascia fissa liscia da entrambi i lati
Fixed smooth jaws both sides



Cod. 6.60.4G100

Art. 610B *

Piastra ganascia dolce / Soft jaw plate



Cod. Art. 610B 6.61.0B100

Art. 610C *

Piastra ganascia liscia / Smooth jaw plate



Cod. Art. 610C 6.61.0C100

Art. 610D *

Piastra ganascia zigrinata / Serrated jaw plate



Cod. Art. 610D 6.61.0D100

Art. 610E *

Piastra ganascia parallela / Parallel jaw plate



Cod. Art. 610E 6.61.0E100

Art. 610F *

Piastra ganascia prismatica / Prismatic jaw plate



Cod. Art. 610F 6.61.0F1000

* Piastrine Art.610B - 610C - 610D - 610E - 610F dimensioni come pagina 6.32 - Jaw plates Art.610B - 610C - 610E - 610F dimensions as page 6.32

Art. 613

Ganascia mobile di spinta
lamping movable jaws



Cod. 6.61.31000

Art. 612

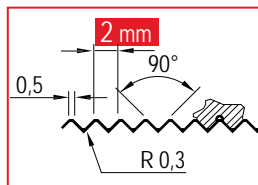

2 mm = Passo delle righe
Rows pitch

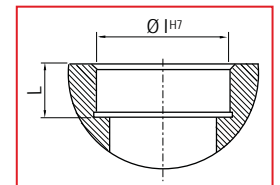

Foro di centraggio
Centering hole

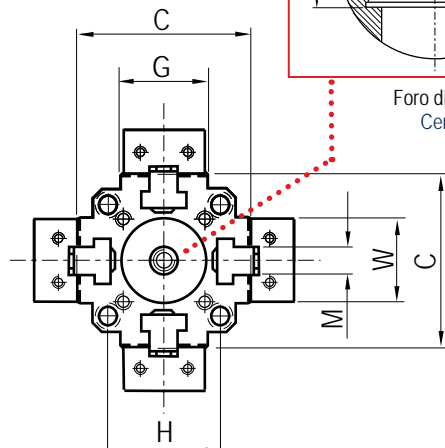
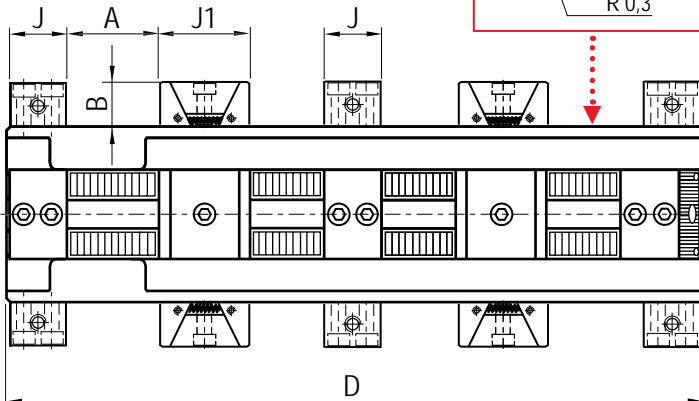

2 30 kN							3 40 kN				
4 x 34mm	4 x 59	4 x 84	4 x 84	4 x 109	4 x 109	4 x 109	4 x 134	4 x 77	4 x 102	4 x 127	4 x 152
	40		40	40		40			60		
	150		230	150	210	240			240		
400	500	600	600	700	700	700	800	700	800	900	1000
	75		75	75		75			100		
	50		50	50		50			70		
	52 / 58		52 / 58	52 / 58		52 / 58			84 / 90		
	100		-	100	-	-	-		150 / 200		
	50		50	50		50			50		
	20		20	20		20			20		
	22		22	22		22			30		
	74		74	74		74			99		
72,4	83,6	94,8	137	106	142,6	170	190	244	268	291	315
6.61.22400	6.61.22600	6.61.22600	6.61.22601	6.61.22700	6.61.22701	6.61.22702	6.61.22800	6.61.23700	6.61.23800	6.61.23900	6.61.23100

I prezzi su fondo rosso sono **comprensivi di base integrale** / Prices on the red background include the solid head plate with the vise-tower

UPGRADE YOUR VISE APPLICATIONS THROUGH MODULAR ACCESSORIES !

6.60.4G200

6.60.4G300

6.61.0B200

6.61.0B300

6.61.0C200

6.61.0C300

6.61.0D200

6.61.0D300

6.61.0E200

6.61.0E300

6.61.0F200

6.61.0F300

* Piastrine Art.610B - 610C - 610D - 610E - 610F dimensioni come pagina 6.32 - Jaw plates Art.610B - 610C - 610E - 610F dimensions as page 6.32

6.61.32000

6.61.33000

Art. 612

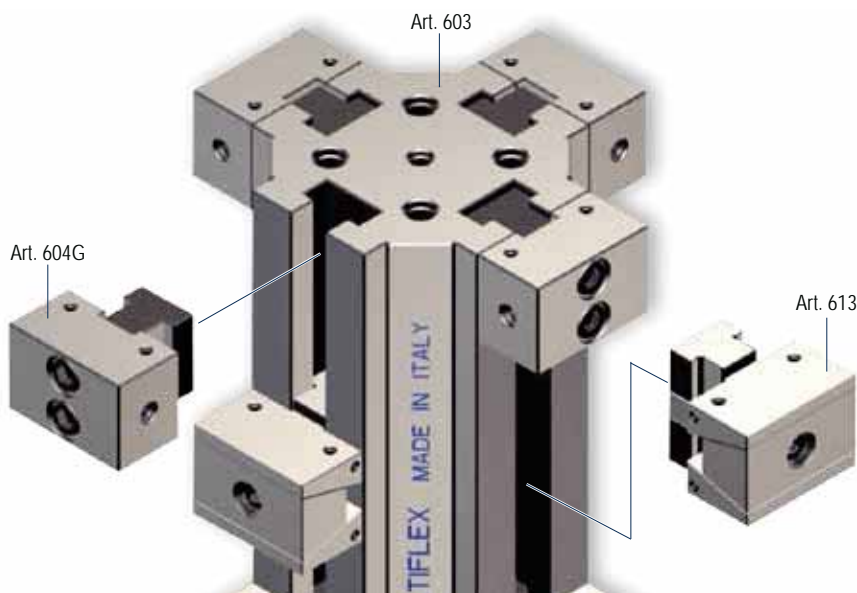

Art. 612	Pag.
n° 1 Art. 603	6.27
n° 12 Art. 604G	6.28
n° 8 Art. 613	6.30

Tipo (grandezza) morsa / Vise (type) size

Art. 601

Corpo base morsa
Vise base body

	1					2						3			
A	34					50						70			
A1	34					54						70			
B	8					12,5						15			
B1	8					10,5						15			
C ⁰ _{-0,02}	50					75						100			
D	300	400	500	600	700	400	500	600	700	800	900	700	800	900	1000
E	37,5					55						75			
F	100					100						100			
G ⁰ _{-0,02}	50					75						100			
Ø P	9					13						17			
Q	100	100	200	300	400	300	200	300	400	500	400	400	500	400	500
S	50					50						50			
Ø F7	10					16						16			
Z	100					100						100			
kg	4,4	5,9	7,3	8,8	10,2	13,9	17,4	20,9	24,4	27,9	31,4	42,5	48	55	60,7
Cod.	6.60.11300	6.60.11400	6.60.11500	6.60.11600	6.60.11700	6.60.12400	6.60.12500	6.60.12600	6.60.12700	6.60.12800	6.60.12900	6.60.13700	6.60.13800	6.60.13900	6.60.13100

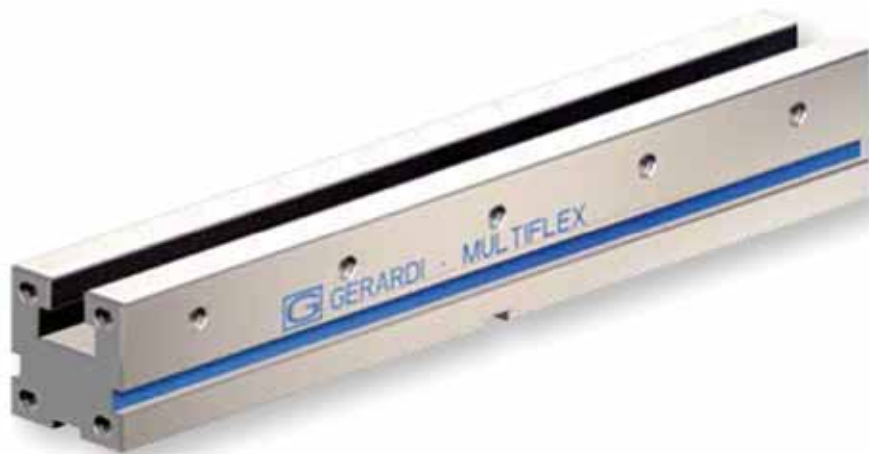

Art. 601

Corpo base morsa
Vise base body

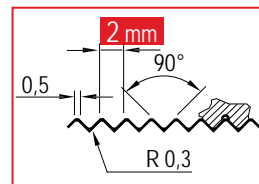
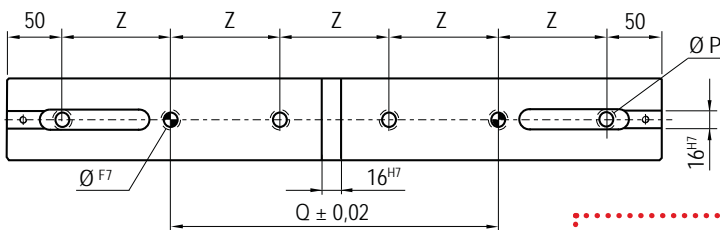

2 mm = Passo delle righe
Rows pitch

Ø = Sede viti calibrate / Hole for calibrated screw

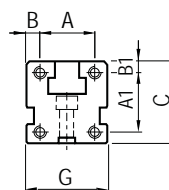
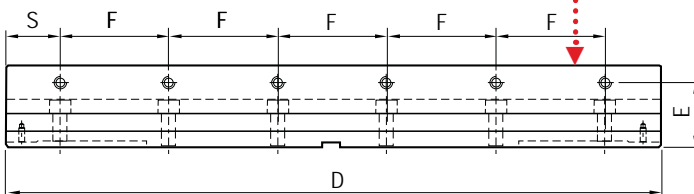

Tipo (grandezza) morsa / Vise (type) size	1					2					3			
---	---	--	--	--	--	---	--	--	--	--	---	--	--	--

Art. 603

Corpo base cubo
Cube base body

C ⁻⁰ / _{-0,02}	100					150			230	150	210	240		240			
D	300	400	500	600	700	400	500	600	600	700	700	700	800	700	800	900	1000
G ⁻⁰ / _{-0,02}	50					75			75	75	75		100				
Ø I ^{H7}	25					50			50	50	50		50				
L ⁻⁰ / _{-0,02}	20					20			20	20	20		20				
kg	15,4	20,5	25,6	30,7	35,8	44,8	56	67,2	110	78,4	115	143	163	164	188	211	235
Cod.	6.60.31300	6.60.31400	6.60.31500	6.60.31600	6.60.31700	6.60.32400	6.60.32500	6.60.32600	6.60.32601	6.60.32700	6.60.32701	6.60.32702	6.60.32800	6.60.33700	6.60.33800	6.60.33900	6.60.33100

I prezzi su fondo rosso sono **comprensivi di base integrale**
Prices on the red background include the solid head plate with the vise-tower



Art. 603

Corpo cubo semplice
Simple cube body

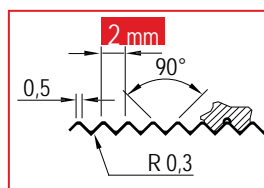

2 mm =
Passo delle righe
Rows pitch

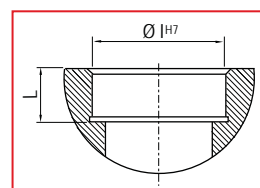

Foro di centraggio
Centering hole

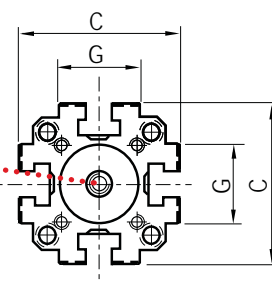
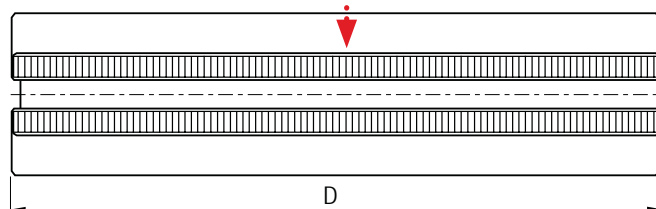

Art. 603

Corpo cubo con base integrale
Cube body with integral base

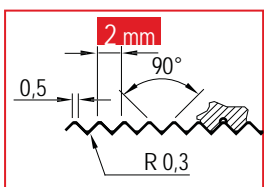

2 mm =
Passo delle righe
Rows pitch

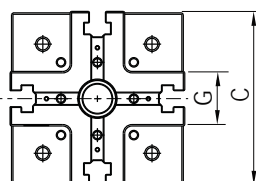
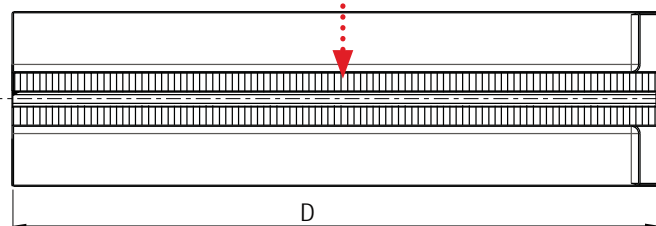

Tipo (grandezza) morsa / Vise (type) size	1	2	3
---	---	---	---

Art. 604

Ganascia fissa (1 lato liscia, 1 lato zigrinata) per morsa Art. 600
Fixed jaw (1 side smooth, 1 side serrated) for vise Art. 600



kg	0,4	1,35	3,84
Cod.	6.60.41000	6.60.42000	6.60.43000

Art. 604G

Ganascia fissa liscia da entrambi i lati, per morsa Art. 611 e cubi Art. 612
Fixed smooth jaw both sides, for vise Art. 611 and cubes Art. 612



kg	0,5	1,40	3,90
Cod.	6.60.4G100	6.60.4G200	6.60.4G300

Art. 604T

Ganascia fissa **GRIP** per morsa Art. 606T
Fixed **GRIP** jaw for vise Art. 606T

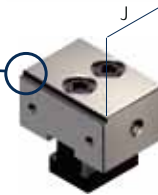
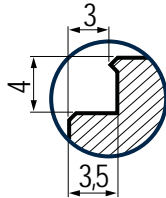

J	38	50	70
Cod.	6.60.4T100	6.60.4T200	6.60.4T300

Art. 608

Ganascia fissa con gradino per morsa Art. 606
Fixed step jaw for vise Art. 606

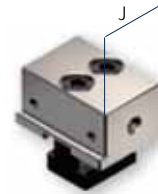

J	38	50	70
kg	0,45	1,4	4
Cod.	6.60.81000	6.60.82000	6.60.83000

Art. 614T

Ganascia fissa con doppio gradino
Fixed jaw with double step



Cod.	6.61.4T100	6.61.4T200	6.61.4T300
------	------------	------------	------------

Art. 604

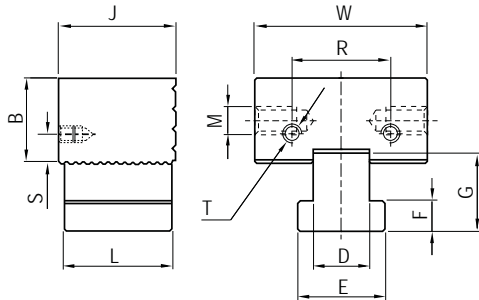

Art. 608

Art. 614T

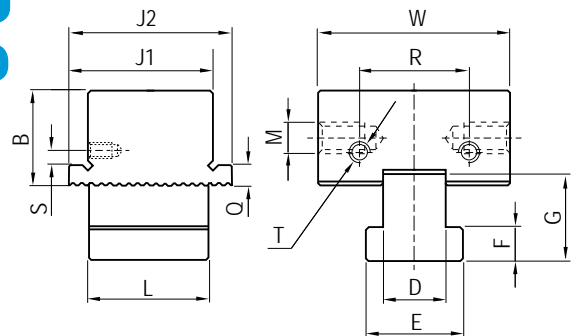

Art.	1	2	3
W	49	74	99
B	25	40	60
D	14	22	30
E	22	35	48
F	8	14	21
G	21	33	46
J	38	50	70
J1	43	55	75
J2	48	60	80
L	30	45	60
M	M10	M10	M10
Q	5	8	10
R	30	50	50
S	7	10	10
T	M5	M6	M6

Tipo (grandezza) morsa / Vise (type) size

1

2

3

Art. 605

Ganascia fissa e mobile liscia per morsa Art. 600
Fixed and movable smooth jaw for vise Art. 600

Ganascia discendente guidata / Sistema a pettine (Particolare)
Guided pull down jaw / Comb system (Detail)

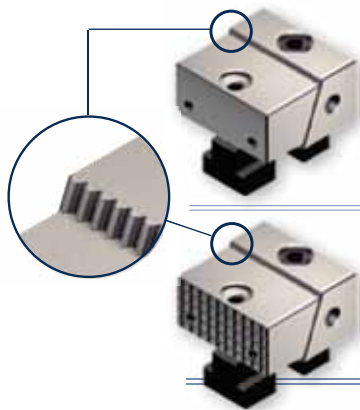

kg	0.6	1.8	4.7
Cod.	6.60.51000	6.60.52000	6.60.53000

Art. 605S

Ganascia fissa e mobile zigrinata per morsa Art. 600
Fixed and movable serrated jaw Art. 600

kg	0.6	1.8	4.7
Cod.	6.60.5S100	6.60.5S200	6.60.5S300

Cod.	6.60.5W100	6.60.5W200	6.60.5W300
------	------------	------------	------------

Art. 605W

Ganascia fissa zigrinata e mobile liscia per morsa Art. 600
Serrated fixed jaw and movable smooth for vise Art. 600

Art. 609

Ganascia fissa e mobile con gradino per morsa Art. 606
Fixed and moving jaw with step for vise Art. 606



kg	0.8	2.2	5.5
Cod.	6.60.91000	6.60.92000	6.60.93000

Art. 609T

Ganascia fissa e mobile GRIP per morsa Art. 606T
Fixed and moving GRIP jaw for vise Art. 606T

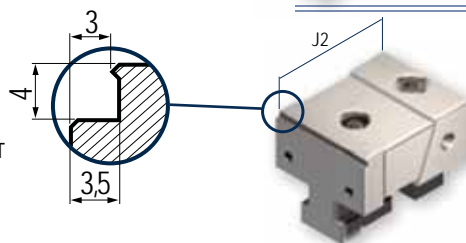

Cod.	6.60.9T100	6.60.9T200	6.60.9T300
------	------------	------------	------------

Art. 605

Art. 605S

Art. 605W

Art. 609

Art. 609T

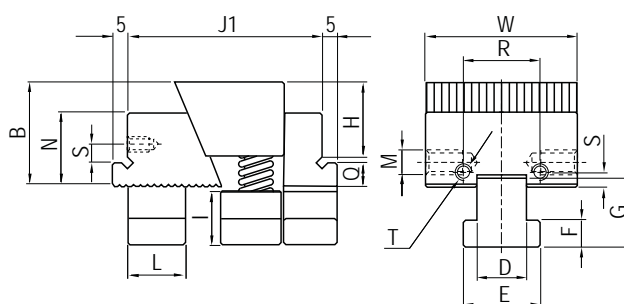
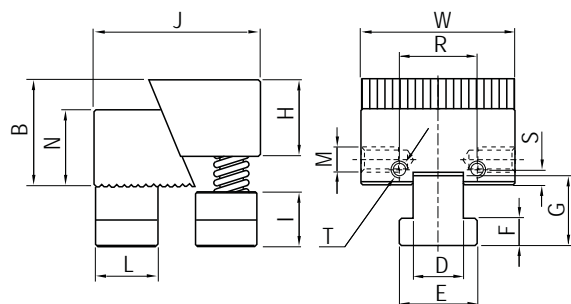

Art.	1	2	3
W	49	74	99
B	35 / 25	40	60
D	14	22	30
E	22	35	48
F	8	14	21
G	25	33	46
H	25	34	50
I	18	26	42
J	54 / 58	70 / 75	94,5 / 98,5
J1	65 / 68	83 / 88	109 / 113
J2	59 / 62	77 / 82	103 / 107
L	22	26	35
M	M10	M10	M10
N	25	40	60
Q	5	8	10
R	30	50	50
S	7	10	10
T	M5	M6	M6

Tipo (grandezza) morsa / Vise (type) size

1

2

3

Art. 613

Ganascia mobile di spinta per morsa Art. 611
Clamping movable jaws for vise Art. 611



kg	0.5	1.4	4.3
Cod.	6.61.31000	6.61.32000	6.61.33000

Art. 615

Ganascia con cuneo di posizionamento maggiorato
Jaw with bigger positioning wedge
(Increased with respect to standard dimensions)



Cod.	6.61.51000	6.61.52000	6.61.53000
------	------------	------------	------------

Art. 613

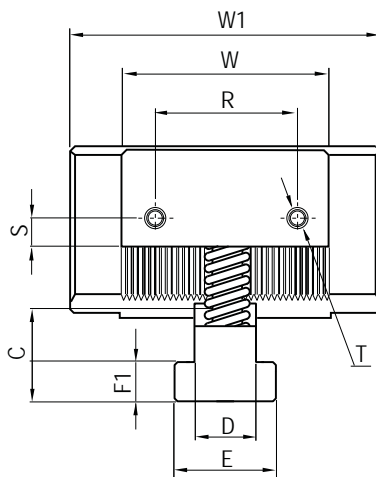
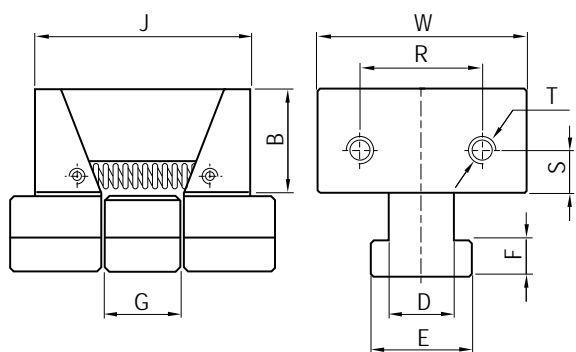

Art. 615

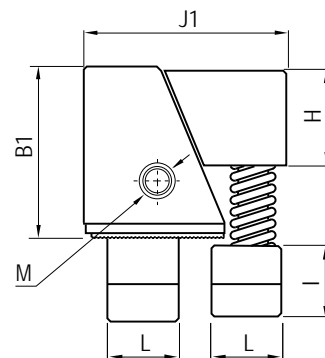

Art.N	1	2	3
W	49	74	99
W1	64	110	150
B	25	40	60
B1	45	60	75
C	21	33	46
D	14	22	30
E	22	35	48
F	9	15	21
F1	8	14	21
G	13	15	25
H	25	34	50
I	18	26	40
J	44 / 50	52 / 58	84 / 90
J1	54 / 58	73 / 79	94.5 / 98.5
L	22	25	35
M	M10	M10	M10
N	45	60	75
R	30	50	50
S	7	10	10
T	M5	M6	M6

6

Tipo (grandezza) morsa / Vise (type) size		1	2	3	
Art. 604	Ganascia fissa / Fixed jaws		Cod. 6.60.41000	6.60.42000	6.60.43000
Art. 604A	Ganascia fissa (un lato liscio e uno zigrinato) Fixed jaw (1 side smooth, 1 side serrated)		Cod. 6.60.4A100	6.60.4A200	6.60.4A300
Art. 604B	Dado a "T" per ganascia fissa / "T" nut for fixed jaw		Cod. 6.60.4B100	6.60.4B200	6.60.4B300
Art. 604C	Vite TCEI fissaggio ganascia fissa Hex socket head screw for fixed jaw		Cod. 6.60.4C100	6.60.4C200	6.60.4C300
Art. 605A	Cuneo di posizionamento / Positioning wedge		Cod. 6.60.5A100	6.60.5A200	6.60.5A300
Art. 605AS	Cuneo di posizionamento zigrinato Serrated positioning wedge		Cod. 6.60.5AS10	6.60.5AS20	6.60.5AS30
Art. 605B	Cuneo di spinta / Clamping wedge		Cod. 6.60.5B100	6.60.5B200	6.60.5B300
Art. 605BS	Cuneo di spinta zigrinato / Serrated clamping wedge		Cod. 6.60.5BS10	6.60.5BS20	6.60.5BS30
Art. 605C	Dado a "T" per cuneo di posizionamento "T" nut for positioning wedge		Cod. 6.60.5C100	6.60.5C200	6.60.5C300
Art. 605D	Dado a "T" per cuneo di spinta "T" nut for clamping wedge		Cod. 6.60.5D100	6.60.5D200	6.60.5D300
Art. 605E	Vite TCEI / TCEI screw		Cod. 6.60.5E100	6.60.5E200	6.60.5E300
Art. 605F	Anello elastico / Seeger		Cod. 6.60.5F100	6.60.5F200	6.60.5F300
Art. 605G1	Vite a gradino / Step screw		Cod. 6.60.5G101		6.60.5G103
Art. 605G2	Perno a molla / Spring pin		Cod. 6.60.5G201	6.60.5G202	6.60.5G203
Art. 605G3	Molla / Spring		Cod. 6.60.5G301		6.60.5G303
Art. 605H	Molla / Spring		Cod. 6.60.5H100	6.60.5H200	6.60.5H300
Art. 605I	Cuneo a spinta dolce / Soft clamping wedge		Cod. 6.60.5I100	6.60.5I200	6.60.5I300
Art. 605L	Cuneo di spinta a "V" / "V" clamping wedge		Cod. 6.60.5L100	6.60.5L200	6.60.5L300
Art. 605M	Rondella / Washer		Cod. 6.60.5M100	6.60.5M200	6.60.5M300
Art. 605N	Anello elastico / Seeger		Cod. 6.60.5N100	6.60.5N200	6.60.5N300

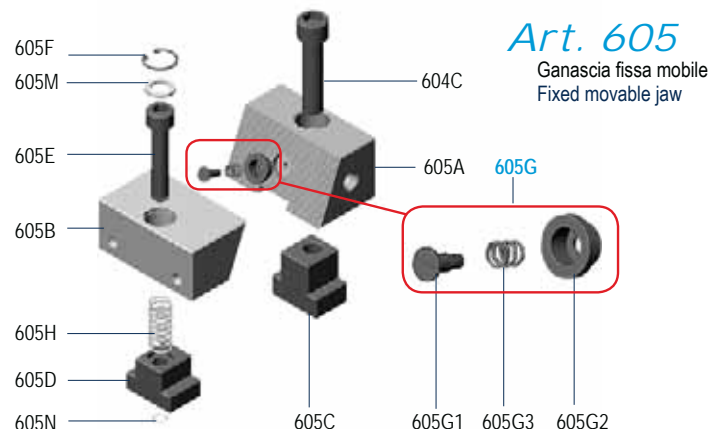
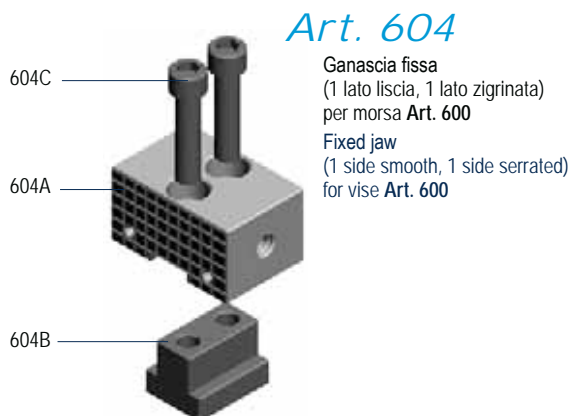

Tipo (grandezza) morsa / Vise (type) size

1 2 3

Art. 605B

Cuneo di spinta
Clamping wedge



Art. 605BT

Cuneo di spinta per piastra GRIP
Clamping wedge for GRIP plate



Cod. Art. 605B	6.60.5B100	6.60.5B200	6.60.5B300
Cod. Art. 605BT	6.60.5BT10	6.60.5BT20	6.60.5BT30

Art. 609A

Cuneo di posizionamento con gradino
Positioning wedge with step



Art. 609AT

Cuneo di posizionamento GRIP
Positioning GRIP wedge



Cod. Art. 609A	6.60.9A100	6.60.9A200	6.60.9A300
Cod. Art. 609AT	6.60.9AT10	6.60.9AT20	6.60.9AT30

Art. 609B

Ganascia mobile guidata con gradino
Movable guided jaw with step



Art. 609BT

Ganascia mobile guidata GRIP
Movable guided GRIP jaw



Cod. Art. 609B	6.60.9B100	6.60.9B200	6.60.9B300
Cod. Art. 609BT	6.60.9BT10	6.60.9BT20	6.60.9BT30

Art. 610B

Piastra ganascia dolce
Soft jaw plate

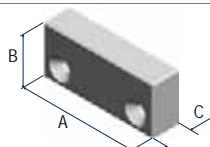

A	48	73	98
B	20	32	50
C	12	18	30
Cod.	6.61.0B100	6.61.0B200	6.61.0B300

Art. 610C

Piastra ganascia liscia
Smooth jaw plate

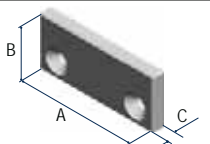

A	48	73	98
B	20	32	50
C	6	10	10
Cod.	6.61.0C100	6.61.0C200	6.61.0C300

Art. 610D

Piastra ganascia zigrinata
Serrated jaw plate

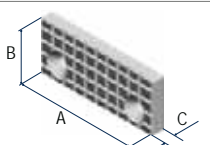

A	48	73	98
B	20	32	50
C	6	10	10
Cod.	6.61.0D100	6.61.0D200	6.61.0D300

Art. 610E

Piastra ganascia parallela
Parallel jaw plate

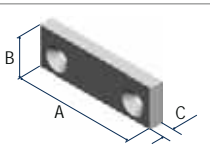

A	48	73	98
B	15	27	45
C	6	10	10
Cod.	6.61.0E100	6.61.0E200	6.61.0E300

Art. 610T

Piastra ganascia GRIP a forte serraggio
GRIP jaw plate for strongest clamping

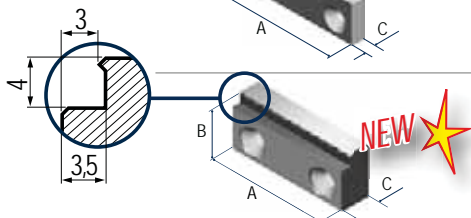

A	48	73	98
B	20	32	50
C	8	10	10
Cod.	6.61.0T100	6.61.0T200	6.61.0T300

Art. 610F

Piastra ganascia prismatica
Prismatic jaw plate

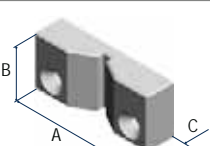

Ø	5 ÷ 35	9 ÷ 50	20 ÷ 80
A	48	73	98
B	20	32	50
C	12	18	30
Cod.	6.61.0F100	6.61.0F200	6.61.0F300

Art. 610Z

Vite per piastre ganasce
Screw for jaw plates



Cod.	6.61.0Z100	6.61.0Z200	6.61.0Z300
------	------------	------------	------------

Art. 609

Ganascia mobile e fissa con gradino
Esempi di combinazioni
Fixed and moving jaw with step
Typical arrangements

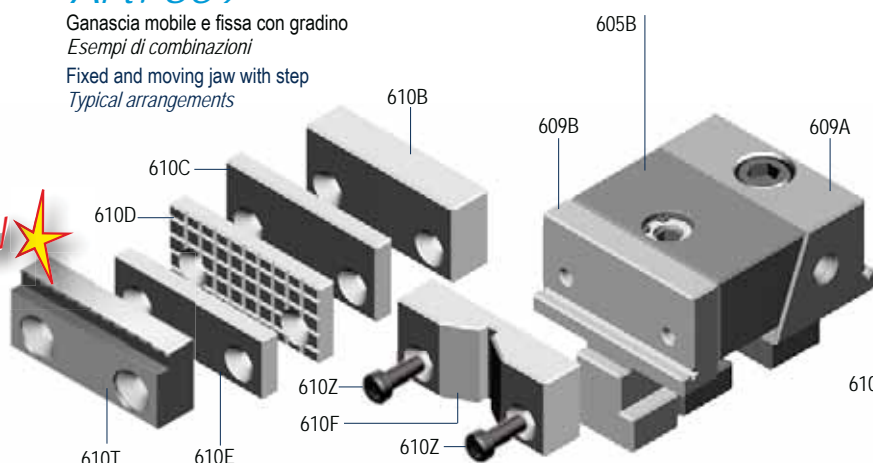

Art. 609T

Ganascia fissa e mobile GRIP
Fixed and movable GRIP jaw

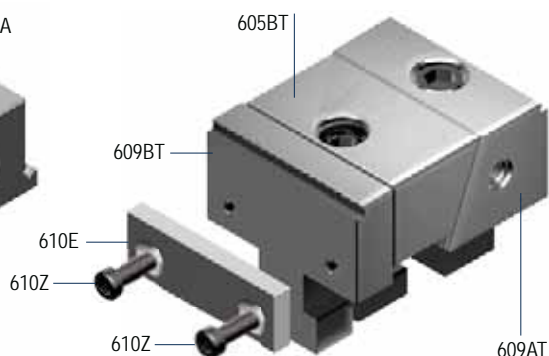

Tipo (grandezza) morsa / Vise (type) size		1	2	3
Art. 608A	Ganascia fissa con gradino / Fixed jaw with step			
Art. 613A	Ganascia mobile / Movable jaw			
Art. 613B	Cuneo di spinta / Clamping wedge			
Art. 613C	Dado a "T" / "T" nut			
Art. 613D	Vite TCEI / Hex socket head screw			
Art. 613E	Grano / Set screw			
Art. 613F	Molla / Spring			
Art. 615A	Cuneo di posizionamento liscio maggiorato Positioning wedge smooth (increased with respect to stand dimension)			
Art. 615AS	Cuneo di posizionamento zigrinato maggiorato Positioning wedge serrated (increased with respect to stand dimension)			
Art. 615I	Cuneo di posizionamento dolce maggiorato Positioning wedge soft (increased with respect to stand dimension)			
Art. 615L	Cuneo di posizionamento a gradino maggiorato Positioning wedge with stop (increased with respect to stand dimension)			
Art. 615C	Vite TCEI fissaggio ganascia fissa Hex socketed head screw for fixed jaw			
Art. 615E	Vite TCEI TCEI screw			

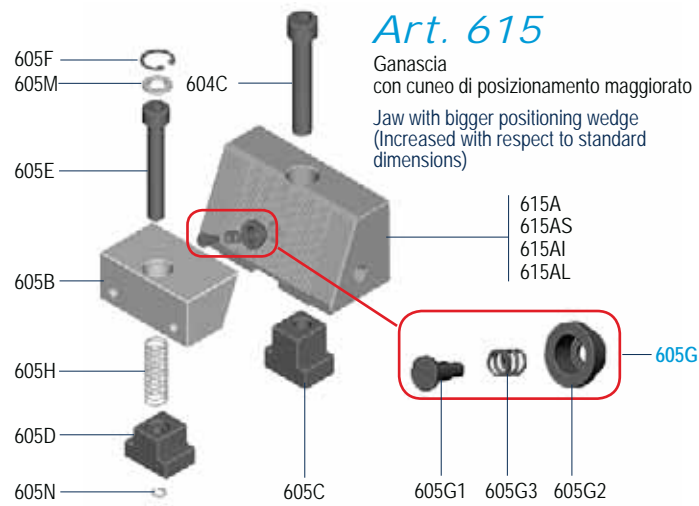
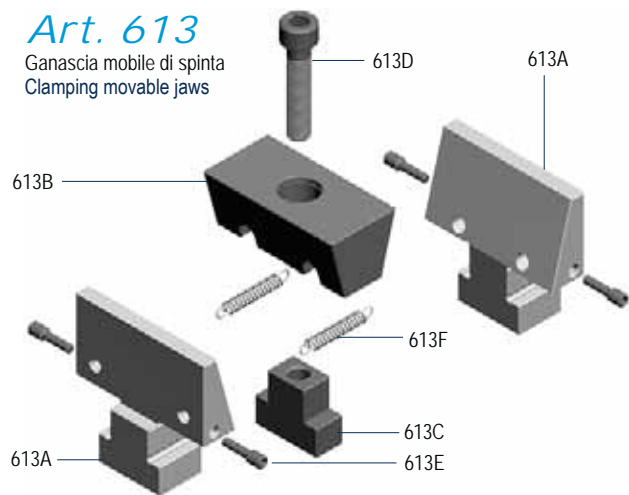

Tipo (grandezza) / (type) size

Base / Base
Ganascia / Jaw

Ti po - Type 2
Tipo - Type 1

Tipo - Type 3
Tipo - Type 1

Tipo - Type 3
Tipo - Type 2

Art. 604B

Dado a "T" per ganascia fissa
"T" nut for fixed jaw

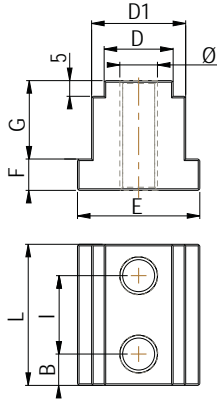

B	6	6	10
D	14	14	22
D1	22	30	30
E	34	39	39
F	10	10	10
G	19	25	25
I	18	18	25
L	30	30	45
Ø	M8	M8	M12
Cod	6.60.4B100/2	6.60.4B100/3	6.60.4B200/3

Art. 605C

Dado a "T" per cuneo di posizionamento
"T" nut for positioning wedge

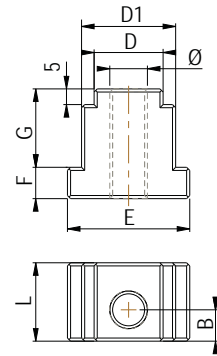

B	9	9	10
D	14	14	22
D1	22	30	30
E	34	39	39
F	10	10	10
G	19	25	25
I	-	-	-
L	22	22	25
Ø	M8	M8	M12
Cod	6.60.5C100/2	6.60.5C100/3	6.60.5C200/3

Art. 605D

Dado a "T" per cuneo di spinta
"T" nut for clamping wedge

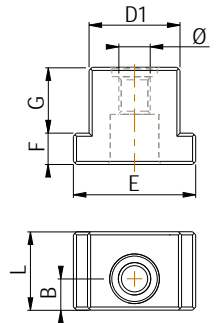

B	9	9	10
D	-	-	-
D1	21	29	29
E	34	39	39
F	10	10	10
G	15	21	21
I	-	-	-
L	21	21	25
Ø	M8	M8	M10
Cod	6.60.5D100/2	6.60.5D100/3	6.60.5D200/3

Dimensioni mm / Dimension mm

1

2

3

Art. 81

Vite calibrata a colletto
per morse Multiflex
Shoulder calibrated screw
for Multiflex vises

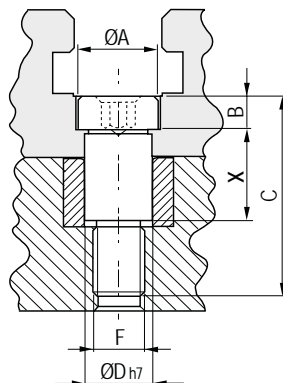

LUNGHEZZA VITI CALIBRATE A COLLETTA PER SOLUZIONI A RETICOLO
SHOULDER CALIBRATED SCREW LENGTHS FOR GRID SOLUTIONS

ØA	13	20	24
B	8	8	12
C	46	65	80
ØD	10	16	16
F	M8	M12	M12
X	25	40	50
Cod	6.81.11025	6.81.21640	6.81.21650

N.B: Per avere altre lunghezze consultare Pag.11.15 - For other lengths see Page.11.15

Tipo (grandezza) morsa / Vise (type) size

1

2

3

Art. 616

Coppia di piastre parallele magnetiche piane
Pair of straight parallels magnetic plates

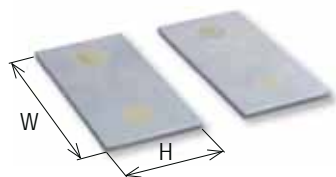

W	49	74	99
H	20	35	55
Cod.	6.61.61000	6.61.62000	6.61.63000

Art. 617

Piastra magnetica a gradino monoblocco
Magnetic solid step jaw plate

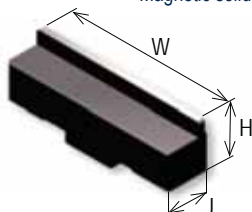

J	12	17	22
W	49	74	99
H	20	35	55
Cod.	6.61.71020	6.61.72035	6.61.73055
€	31	52	72

Art. 618

Ganascia mobile intermedia
Intermediate movable jaw

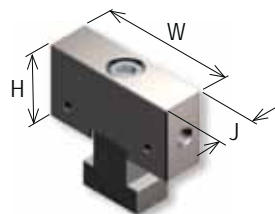

J	16	22	29
W	49	74	99
H	25	40	60
Cod.	6.61.81000	6.61.82000	6.61.83000

Art. 604PB

Piastra ganascia fissa di partenza
Fixed start jaw plate

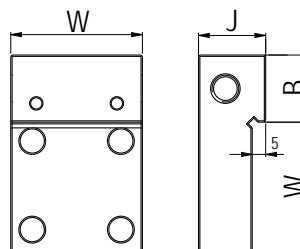

W	49	74	99
J	25	30	35
B	25	40	60
Cod	6.60.4PB10	6.60.4PB20	6.60.4PB30

Art. 604PC

Piastra ganascia fissa di partenza per cubo-morsa
Fixed start jaw plate for vise tower

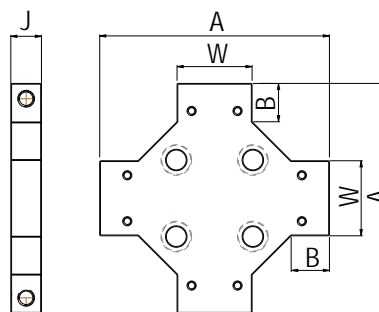
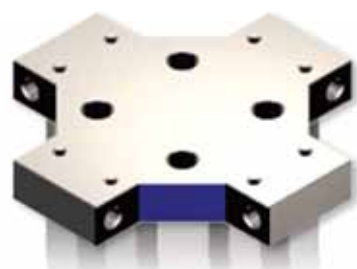

*A	150	230	290	310	320	360
W	49	74	99			
J	20	25	30			
B	25	40	60			
Cod	6.60.4PC10	6.60.4PC20	6.60.4PC30			

* Scegliere la dimensione A in funzione del cubo utilizzato, vedi Art.603 a pag. 6.27 - Referring to the cube you are using, choose dimension *A, see Art.603 page. 6.27



Dimensioni *Dimensions*

A	B	C	E	H	kg	Art. 57F 40		Art. 57F 50	
						Cod.		Cod.	
200	500	40	80	750	154	8.57.F40100		8.57.F00100	
200	500	40	80	650	140	8.57.F40105		8.57.F00105	
250	500	40	80	750	194	8.57.F40106		8.57.F00106	
270	500	40	80	850	232	8.57.F40110		8.57.F00110	
230	500	40	110	850	214	8.57.F40120		8.57.F00120	
300	500	40	150	850	264	8.57.F40130		8.57.F00130	
300	630	40	150	950	322	8.57.F40140		8.57.F00140	
370	500	40	200	950	379	8.57.F40145		8.57.F00145	
400	500	50	100	850	228	8.57.F.40150		8.57.F00150	

Art. 57F

Cubo a croce
Cross tower

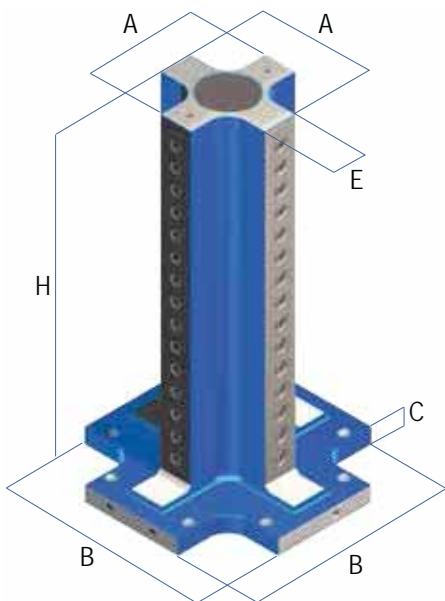

Art. 57F 40 / 57F 50

Croce a reticolo con bussole temprate 100Cr6 e filetti riportati in acciaio inox
Tolleranza $\pm 0,02$ mm

- Interasse reticolo 40 mm = $\varnothing 12 / M10$
- Interasse reticolo 50 mm = $\varnothing 16 / M12$

Crosscube grid type with hardened bushing 100Cr6 and inox steel helicoils
Tolerance $\pm 0,02$ mm

- Grid pitch 40 mm = $\varnothing 12 / M10$
- Grid pitch 50 mm = $\varnothing 16 / M12$

Dimensioni *Dimensions*

A	B	C	D	E	F	H	K	L	kg	Cod.
200	500	40	350	80	16	750	50	M12	154	8.57.G00100
200	500	40	350	80	16	650	50	M12	140	8.57.G00105
250	500	40	400	80	16	750	50	M12	194	8.57.G00106
270	500	40	450	80	16	850	50	M12	232	8.57.G00110
230	500	40	450	110	16	850	50	M12	214	8.57.G00120
300	500	40	450	150	16	850	50	M12	264	8.57.G00130
300	630	40	500	150	16	950	50	M12	322	8.57.G00140
370	500	40	500	200	16	950	50	M12	379	8.57.G00145
400	500	50	450	100	16	850	50	M12	228	8.57.G00150

Art. 57G

Cubo a croce per morse Multiflex
Cross tower for Multiflex vises

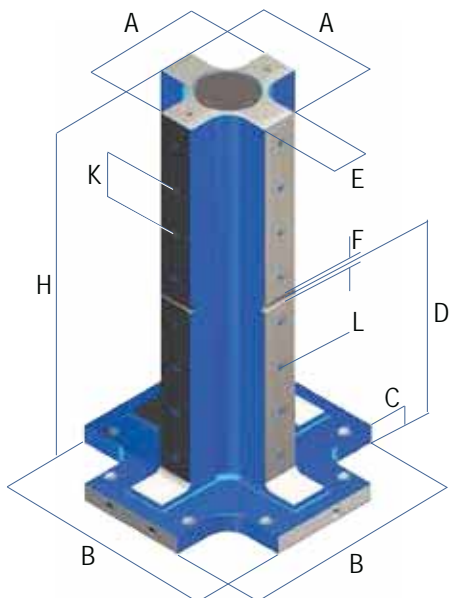

6

SERRAGGIO MECCANICO CON CHIAVE DINAMOMETRICA

MECHANICAL CLAMPING WITH TORQUE WRENCH

I diagrammi seguenti consentono di determinare le forze di serraggio ottenibili con le morse di varia grandezza (da 1 a 3), in funzione della forza applicata

The following diagrams give the clamping force that can be obtained with each vise type (size 1 to 3) as a function of wrenching force

MORSE MULTIFLEX TIPO 1
MULTIFLEX VISES TYPE 1

Ganascia fissa e cuneo di posizionamento:
Momento applicato 40Nm
 Fixed jaw and positioning Wedge: Torque 40Nm

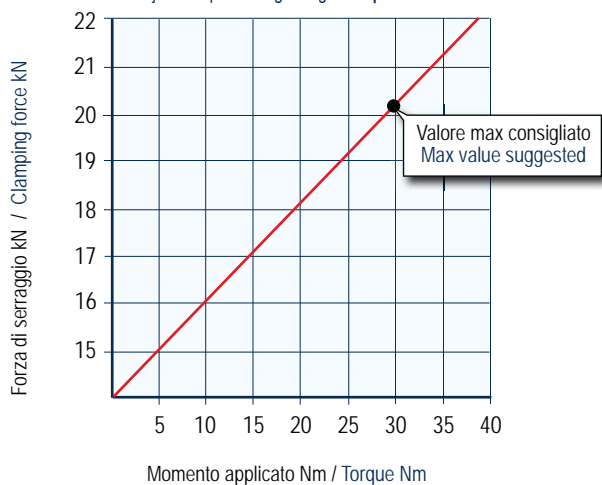

MORSE MULTIFLEX TIPO 2
MULTIFLEX VISES TYPE 2

Ganascia fissa e cuneo di posizionamento:
Momento applicato 120Nm
 Fixed jaw and positioning Wedge: Torque 120Nm

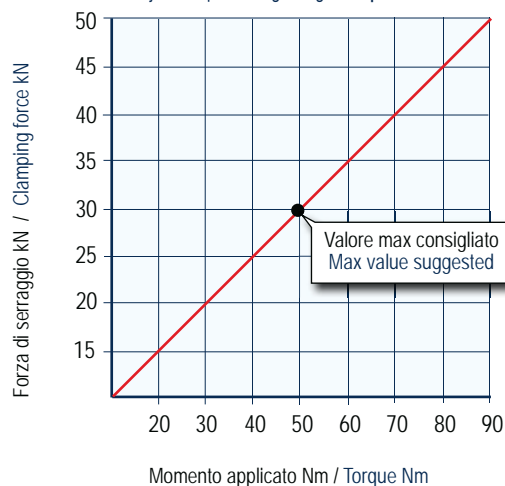

MORSE MULTIFLEX TIPO 3
MULTIFLEX VISES TYPE 3

Ganascia fissa e cuneo di posizionamento:
Momento applicato 250Nm
 Fixed jaw and positioning Wedge: Torque 250Nm

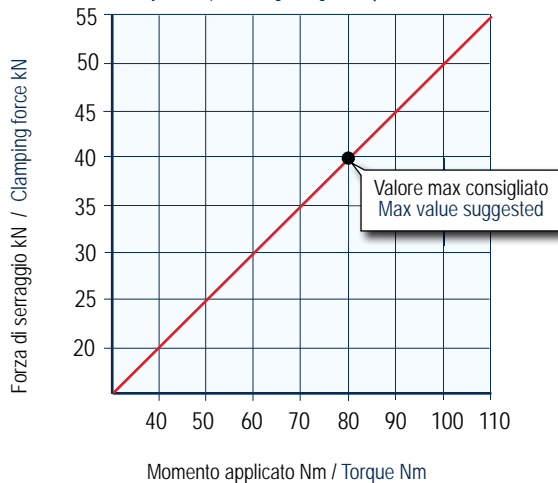

NB: Alcuni fattori, come la lubrificazione, lo staffaggio, gli attriti ed altro, possono modificare i valori indicati fino a $\pm 10\%$. Per un corretto utilizzo non superare i valori indicati nel grafico

Some factor as lubrication, clamping on the machine table, frictions and more can modify above values within a $\pm 10\%$ range. For optimum operation do not exceed chart values.

TOLLERANZE GEOMETRICHE

GEOMETRIC ACCURACIES

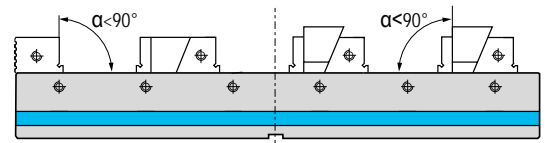
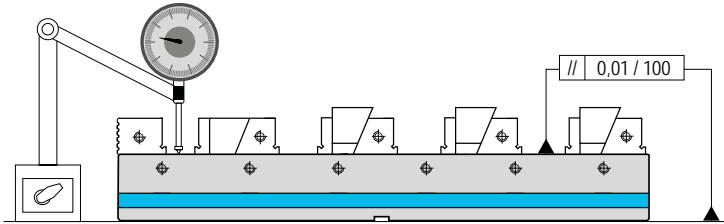
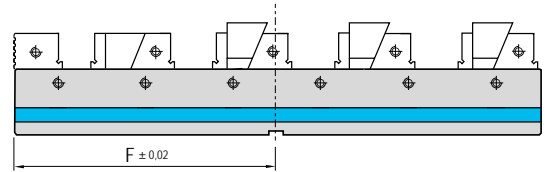
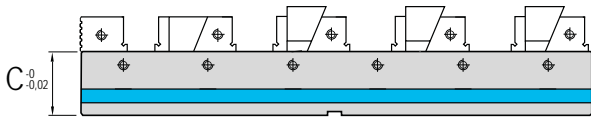

TOLLERANZE DINAMICHE

DINAMIC ACCURACIES

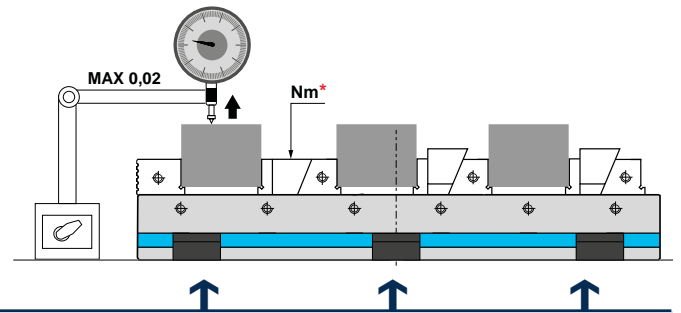
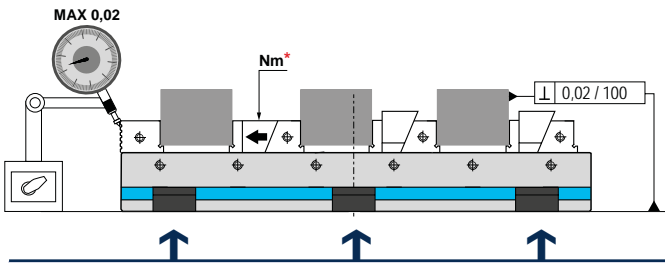

Morsa ancorata con 2 coppie di staffe Art. 296 / Vise clamped with n. 2 pairs of Art. 296

Art 600 - 606 - 611

* Momento applicato - Torque **Nm**

Forza di serraggio - Clamping power **Kgf**

Ganascia fissa e Cuneo di posizionamento
Fixed jaw and positioning Wedge

Cuneo di spinta - Clamping movable Jaw

Cuneo di spinta - Clamping movable Jaw

Morsa - Vise Art. 600 Morsa - Vise Art. 606 Morsa - Vise Art. 611

Morsa - Vise Art. 600 Morsa - Vise Art. 606 Morsa - Vise Art. 611

Ganascia Tipo 1 Jaw Type 1

40

30

2000

Ganascia Tipo 2 Jaw Type 2

120

50

3000

Ganascia tipo 3 Jaw Type 3

250

100

4000

1 kgf . m = 9.806 Nm



Morsa Art. 606 con piastrine prismatiche
Art. 610F per serraggio pezzi tondi
Vise Art. 606 with prismatic jaw plates
Art 610F for round workpieces clamping

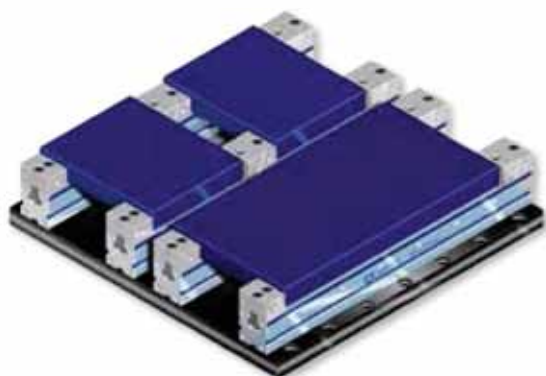

Esempio di applicazione di 4 morse **MULTIFLEX**
su sovratavola per diversi tipi di serraggio e lavorazione
4 **MULTIFLEX** vises assembled on head plate
for different workpieces clamping and machining

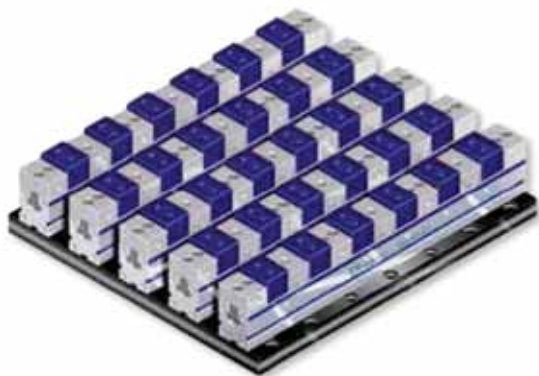

Esempio di applicazione di 5 morse **MULTIFLEX**
su sovratavola per serraggio di 30 pezzi
5 **MULTIFLEX** vises on head plate
for 30 workpieces clamping



Cubo a croce Art. 57G con
vari tipi di morsa Gerardi
Crosscube Art. 57G with various
Gerardi vises assembled on



Cubo a croce Art. 57G con morsa Multiflex
Crosscube Art. 57G with Multiflex vises



Cubo multiflex Art. 602 con piastra base integrale
Crosscube Art. 602 with solid base



IN LINEA - IN LINE

n.6 Morse **MULTIFLEX Art.600** tipo 2x600,
 per il serraggio di 7 pezzi di dimensioni 80x360
 # 6 **MULTIFLEX** vises **Art.600** type 2x600,
 for 7 workpieces clamping 80x360

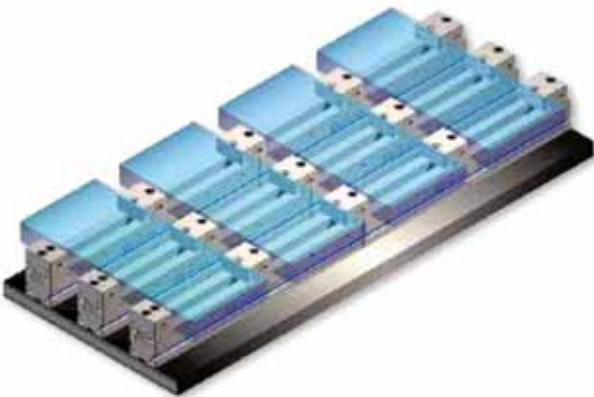

IN LINEA - IN LINE

n.6 Morse **MULTIFLEX Art.600** tipo 2x600,
 per il serraggio di 4 pezzi di dimensioni 250x500
 # 6 **MULTIFLEX** vises **Art.600** type 2x600,
 for 4 workpieces clamping 250x500

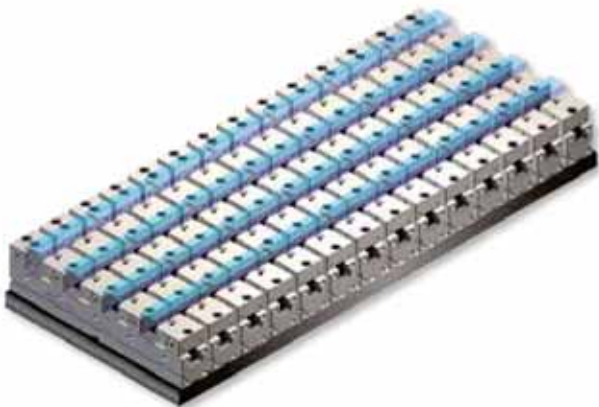

IN PARALLELO - PARALLEL

n.14 Morse **MULTIFLEX Art.600** tipo 2x500,
 per il serraggio di 28 pezzi di dimensioni 160x40
 # 14 **MULTIFLEX** vises **Art.600** type 2x500,
 for 28 workpieces clamping 160x40



n.14 Morse **MULTIFLEX Art.600** tipo 2x500,
 per il serraggio di 14 pezzi di dimensioni 80x360
 # 14 **MULTIFLEX** vises **Art.600** type 2x500,
 for 14 workpieces clamping 80x360